

# Installation manual

## Electric pre/post heating Modular T

D-EIMOC2009-22\_00EN



› Modular T

Original translations

REV	00
DATE	October 2022
REPLACES	

# 1 Important warnings



The pictogram shows a situation of immediate danger or a dangerous situation that might cause injuries or death.



The pictogram shows that it is necessary to adopt suitable behaviour in order to avoid jeopardising staff safety and cause damages to the equipment.



The pictogram shows particularly important technical information that should be taken into consideration by the people installing or using the equipment.



Read this manual carefully before installation and keep it for any further future consultation by the various operators. Do not remove, tear out or rewrite any part of this manual.



**Failure to follow these instructions may cause damage and injuries, even fatal, voids the warranty and relieves the Manufacturer of any liability.**



All installation, assembly, electrical connections to the mains and ordinary/extraordinary maintenance must be performed **only by technicians complying with the legal requirements**, after turning off the unit and using personal protective equipment (i.e. gloves, protective goggles, etc.), in compliance with the regulations in force in the country the equipment is to be used in and the laws on safety in the workplace.



Installation, use or maintenance other than those specified in the manual may cause damage, injury or death, invalidate the warranty and relieve the Manufacturer of all liability.



Use protective clothing and suitable equipment while handling or installing the equipment, in order to prevent accidents and safeguard your own and other people's safety. Individuals not assigned to installation or maintenance are NOT allowed to stand or pass through the work area while the unit is assembled.



**Before carrying out any installation, disconnect the equipment from the power supply and wait at least 120 seconds before carrying out any operation.**



It is the responsibility of the user/installer to check the static and dynamic stability relative to the installation and to arrange environments so that **people who are not competent or authorised DO NOT have access to the unit or to its controls.**

## 2 Technical data

### Modular T PRO

Size	Material name	Load kW	A mm	B mm	C mm	D mm	Weight kg	Supply voltage
03	ATD03HEFAU	12	518	416	71	250	8,6	3-phase; 400V
	ATD03HESAU	4.5	389	290	71	250	5.8	3-phase; 400V
04	ATD04HEFAU	15	651	548	71	315	15.4	3-phase; 400V
	ATD04HESAU	6	393	291	71	315	8.7	3-phase; 400V
05	ATD05HEFAU	18	651	548	72	355	17.4	3-phase; 400V
	ATD05HESAU	6	389	287	72	355	9.4	3-phase; 400V
06	ATD06HEFAU	21	774	672	71	400	22.3	3-phase; 400V
	ATD06HESAU	7.2	389	286	71	400	10.5	3-phase; 400V
07	ATD07HEFAU	24	902	800	71	500	29.4	3-phase; 400V
	ATD07HESAU	8.4	518	416	71	500	15.1	3-phase; 400V

### Modular T SMART

Size	Material name	Load kW	A mm	B mm	C mm	D mm	Weight kg	Supply voltage
03	ATD03HEFBU	12	518	416	71	250	8,4	3-phase; 400V
04	ATD04HEFBU	15	651	548	71	315	15.2	3-phase; 400V
05	ATD05HEFBU	18	651	548	72	355	17.2	3-phase; 400V
06	ATD06HEFBU	21	774	672	71	400	22	3-phase; 400V
07	ATD07HEFBU	24	902	800	71	500	29.2	3-phase ; 400V
			389	291	71	315	7,2	1-phase ; 230V

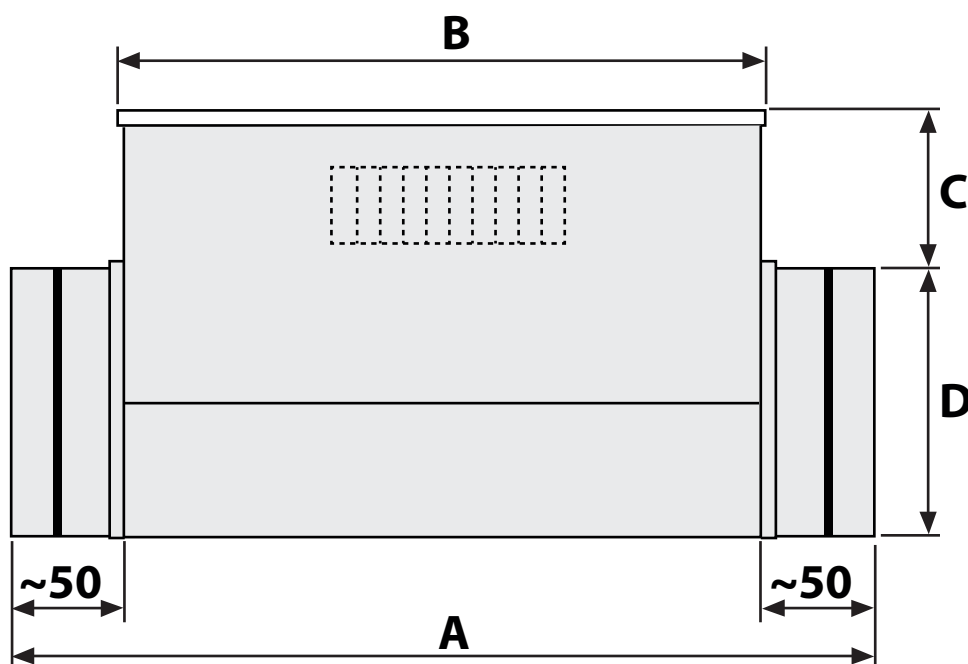

## MODULART PRO

## MODULART SMART

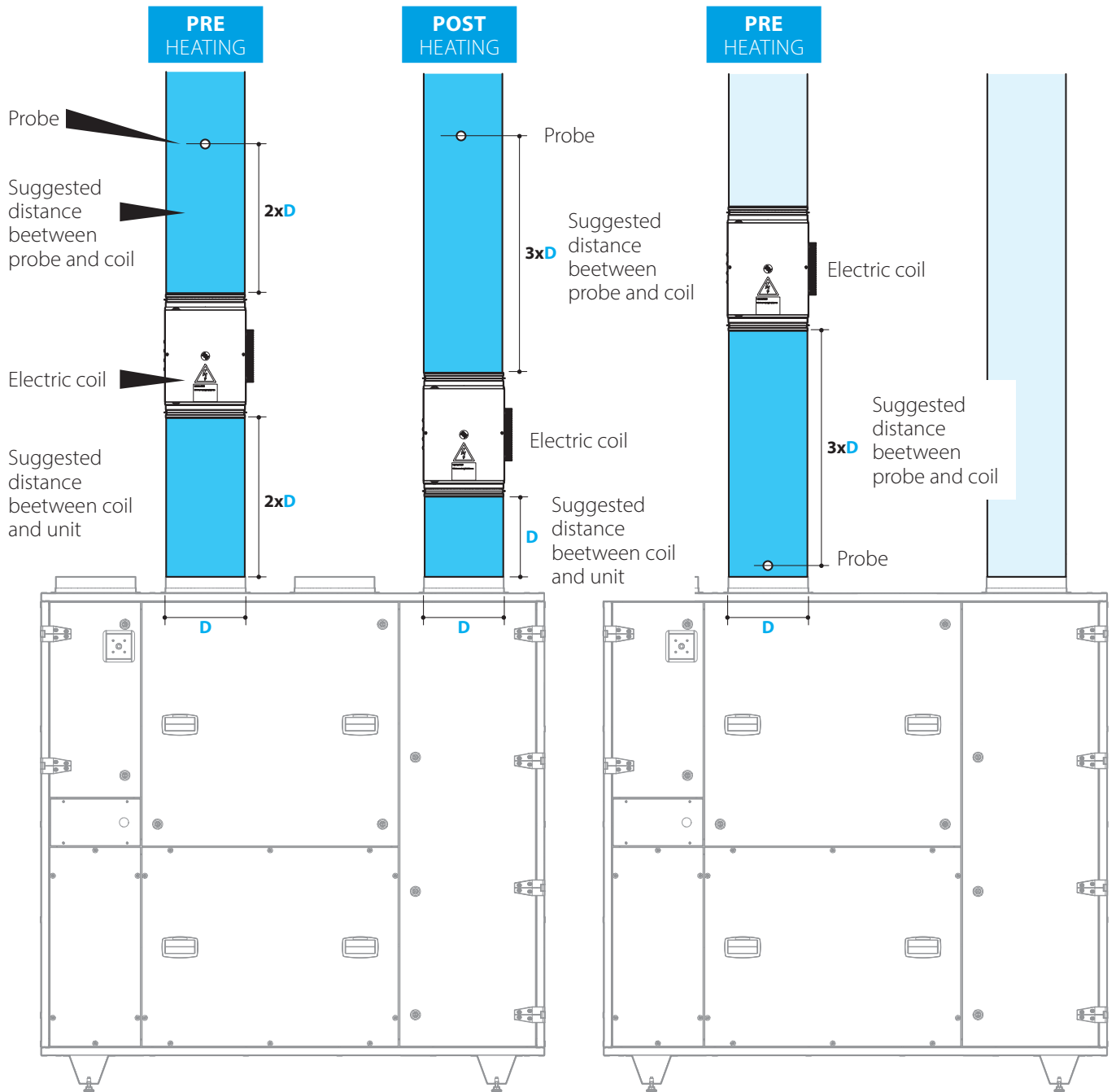

$D^*$  = diameter of ducts

(e.g. if  $D = 250 \text{ mm}$   $\rightarrow 1xD = 250 \text{ mm}$ ,  $2xD = 500 \text{ mm}$ ...)

**1** Correct distance

# 3 Installation

## MODULART PRO

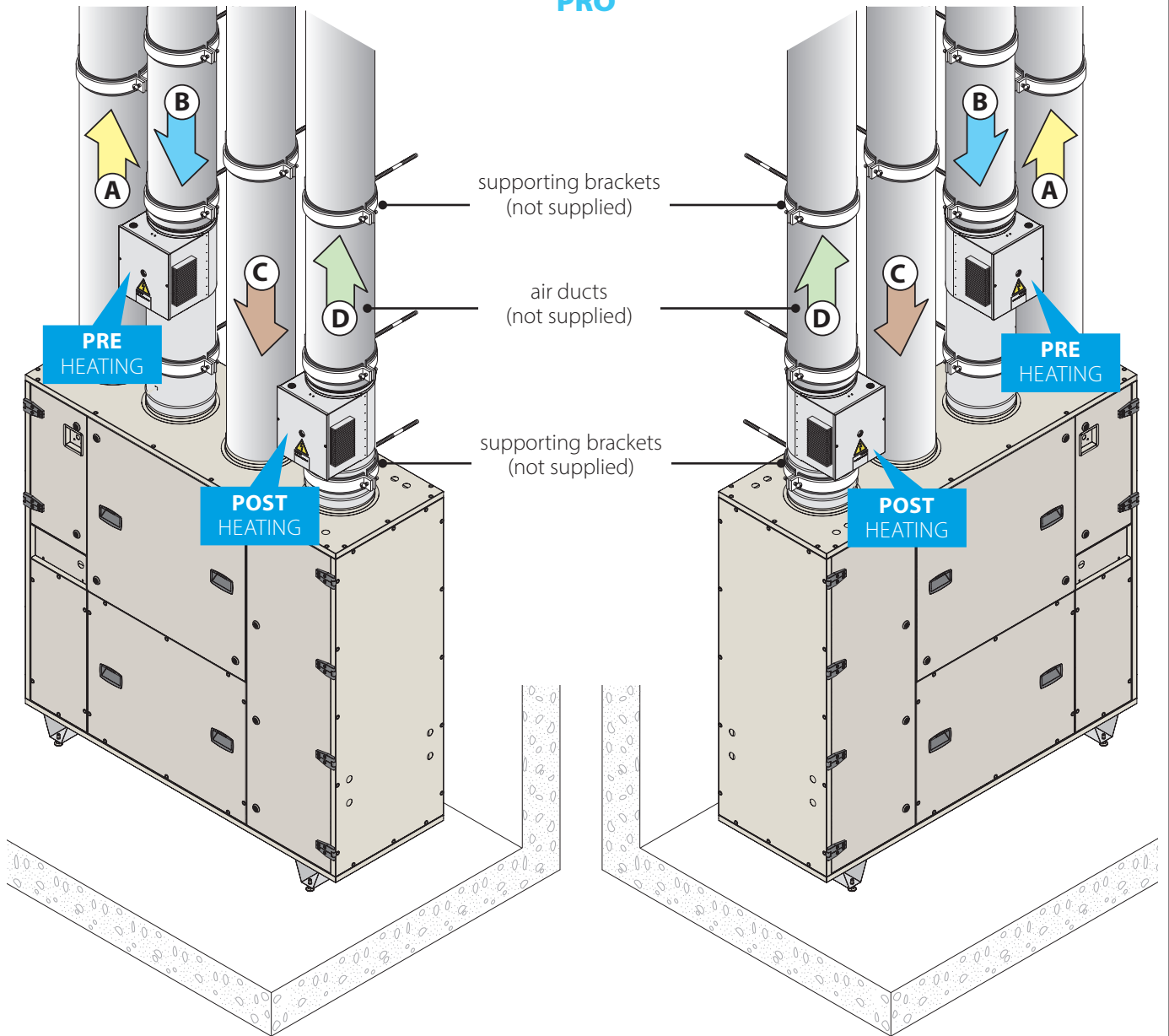

**Right Handling**  
VERSION MACHINES  
**ATB\*\*R\*\***

**Left handling**  
VERSION MACHINES  
**ATB\*\*L\*\***

### DUCT

- A** Exhaust air
- B** Fresh air
- C** Return air
- D** Supply air

## 2 Machine duct, example

## MODULAR T SMART

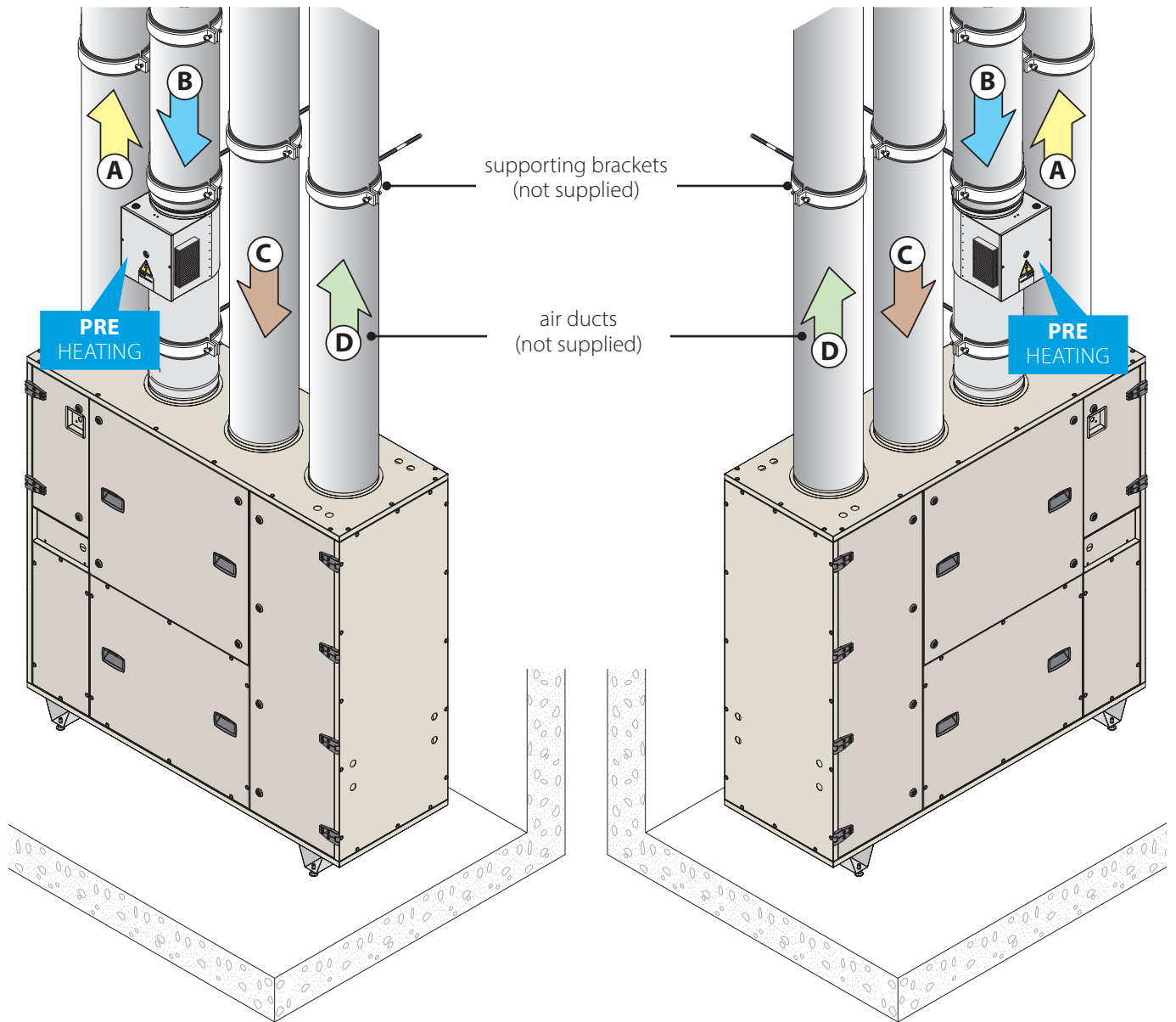

**Right Handling**  
VERSION MACHINES  
**ATB\*\*R\*\***

**Left handling**  
VERSION MACHINES  
**ATB\*\*L\*\***

### DUCT

- A** Exhaust air
- B** Fresh air
- C** Return air
- D** Supply air

## 4 Machine duct, example

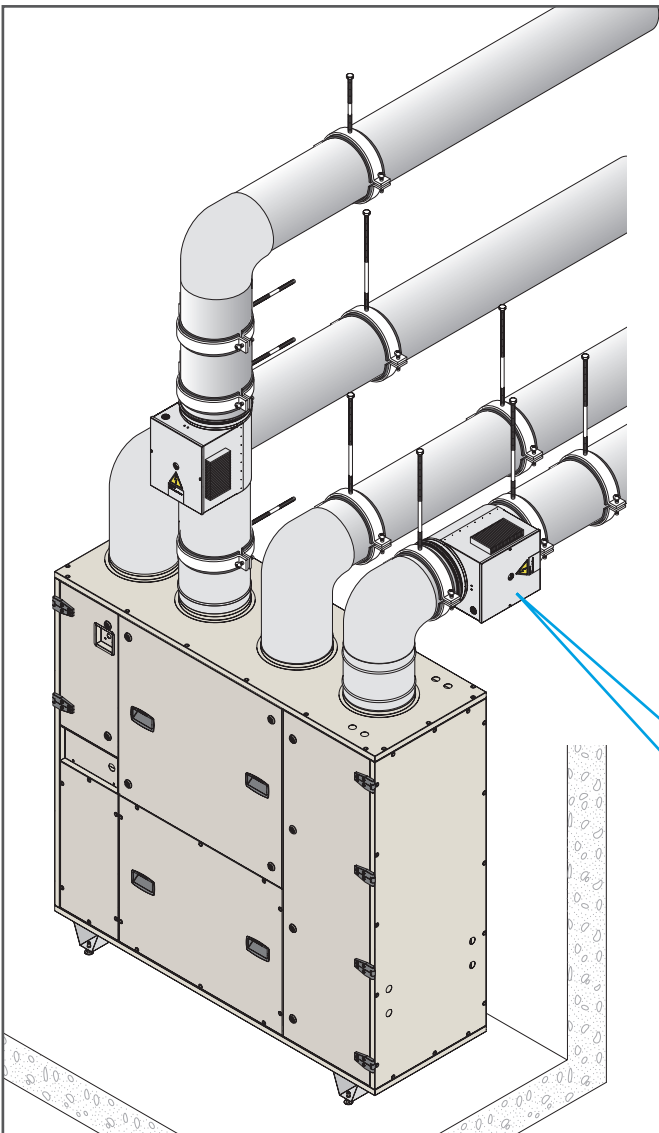

Electric post/pre heating coil can be positioned both **horizontally** and **vertically**. The ducts and the electric coils must be **permanently fixed to a fixed structure** (for example a wall or a ceiling) using brackets (not supplied). Electric post/pre heating coil should be installed in such a way that it is accessible for maintenance or any other operation. **The electric post/pre heating coil should not be facing down.**



Provide thermal insulation (not supplied) around the electric coils because they reach high temperatures (<60 °C).

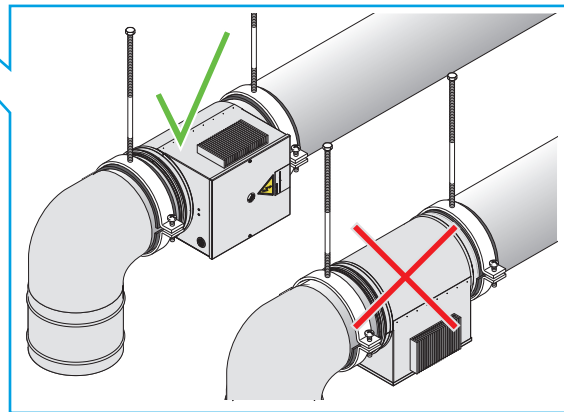

**5** Example of installation of the electric post/pre heating both horizontally and vertically

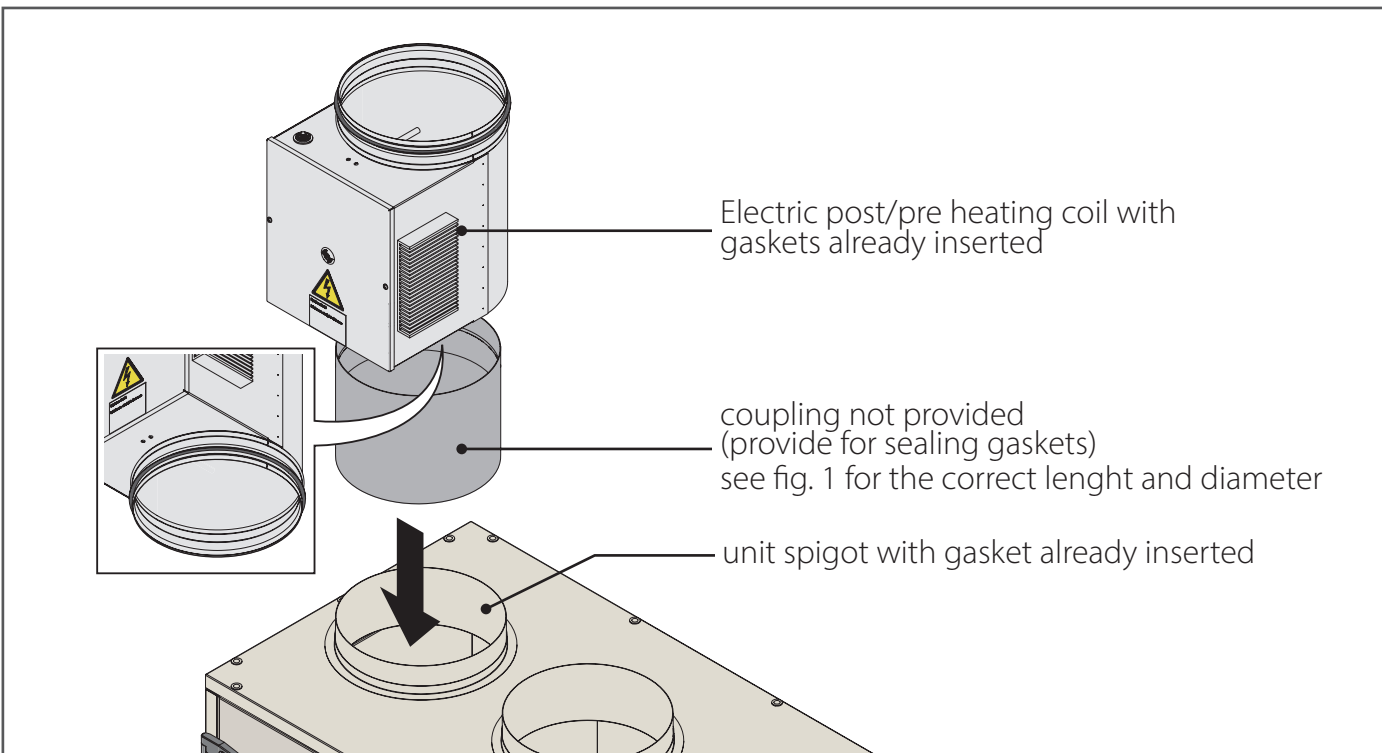

**6** Installation of electric pre/post heating

# 4 Electrical connections

## Power supply

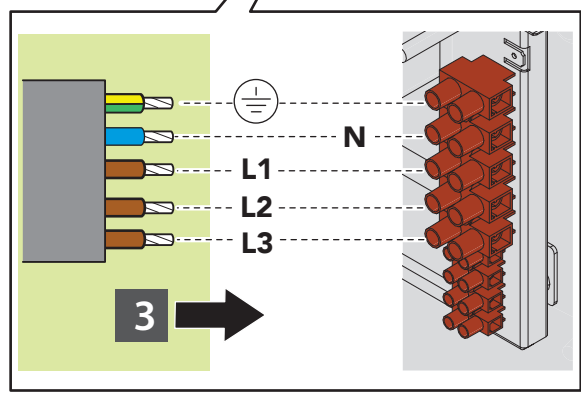
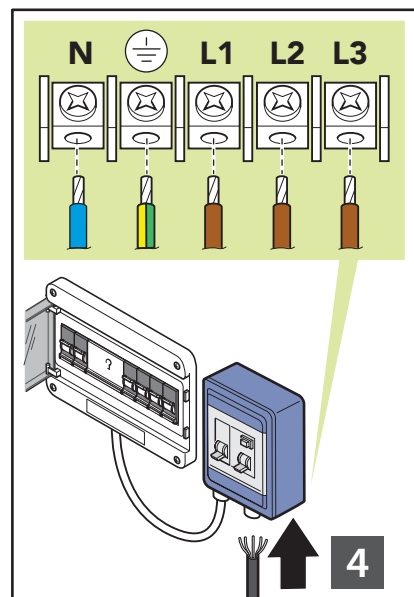
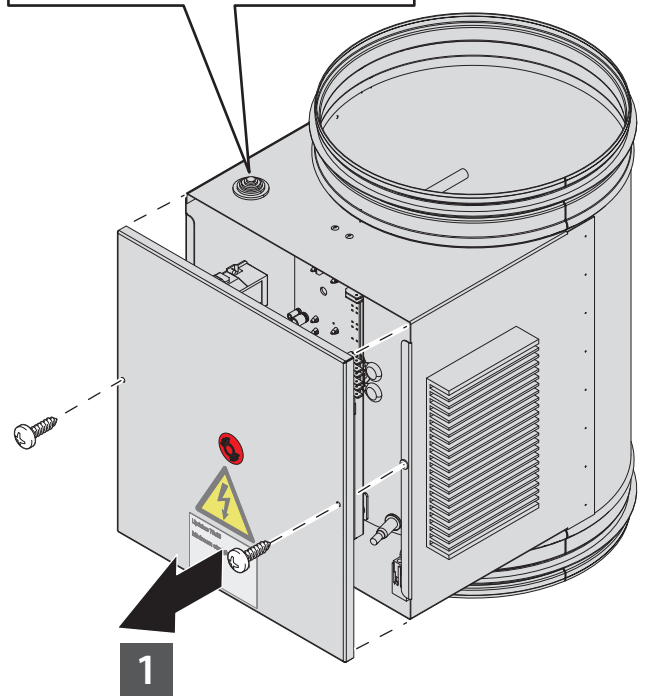
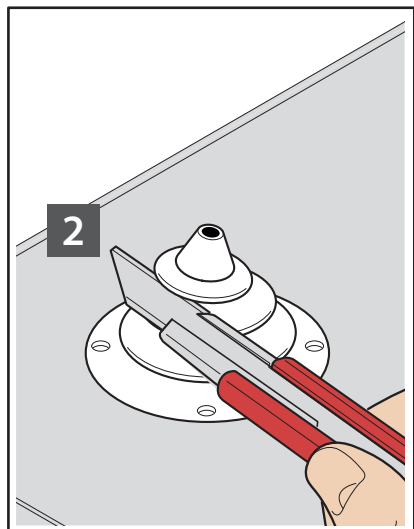



# Modular T Smart version only

## Connection of PRE-HEATING probe

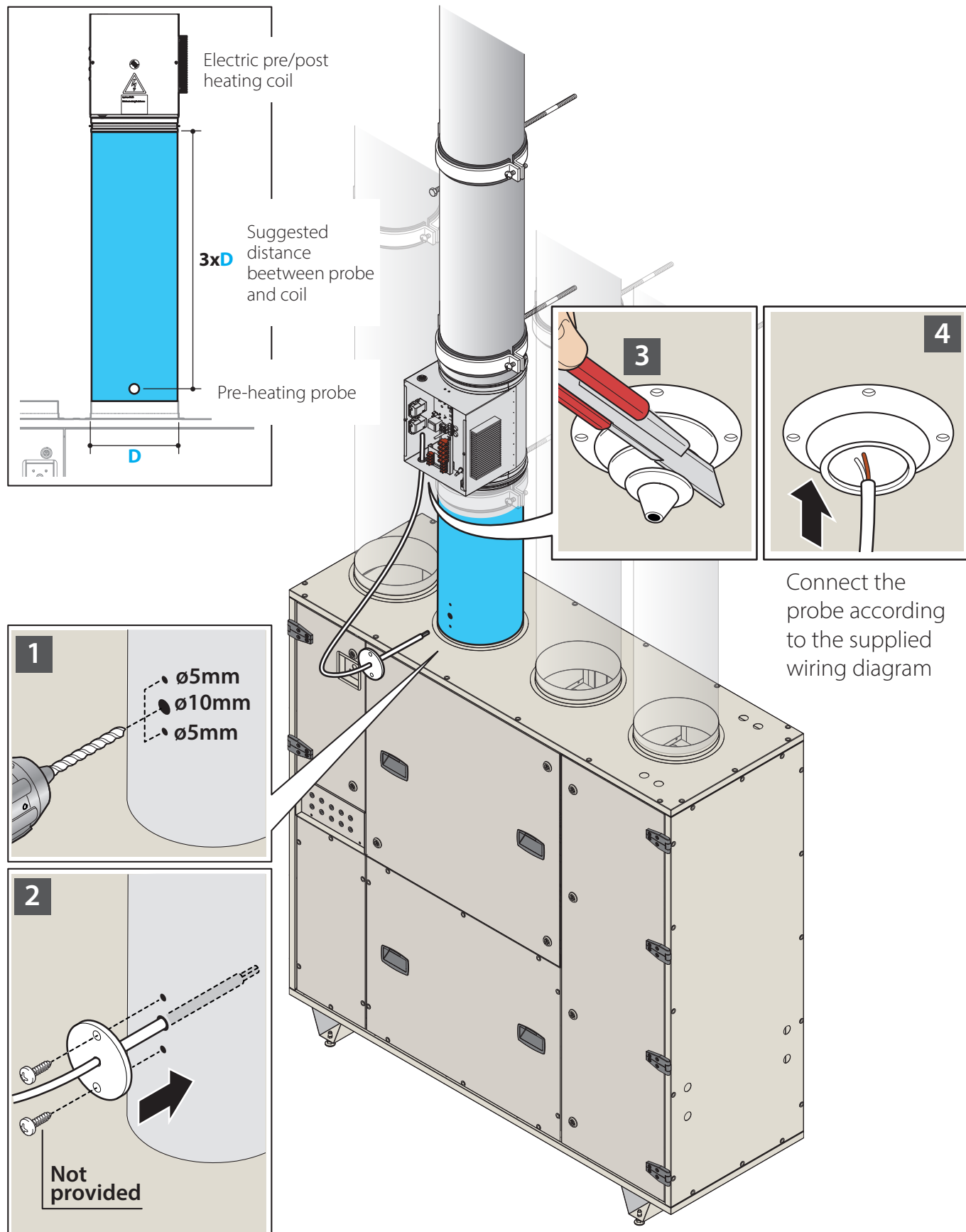

### Potentiometer

set the target temperature

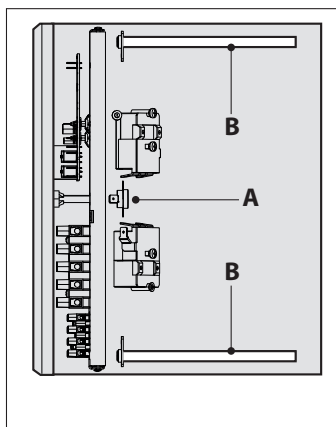
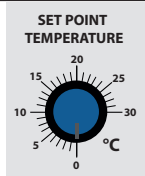

### Reset button

the electric coils have 3 safety thermostats that intervene in case of high temperature; the thermostats (B) are set at 50 °C and are self-resetting, while the thermostat (A) is set at 100 °C and must be manually reset by pushing the reset button

The electric coil has an alarm contact that may be used to trigger a warning system (not provided).

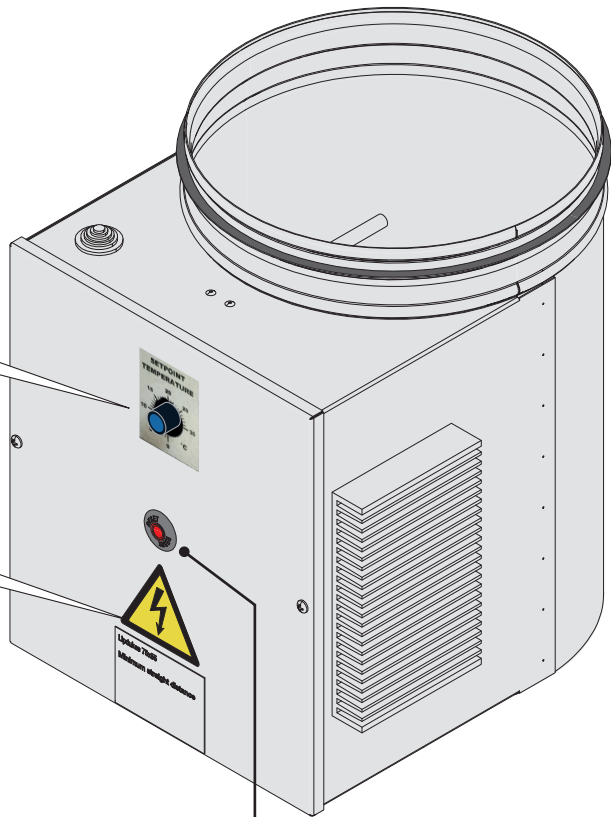

# Modular T Pro version only

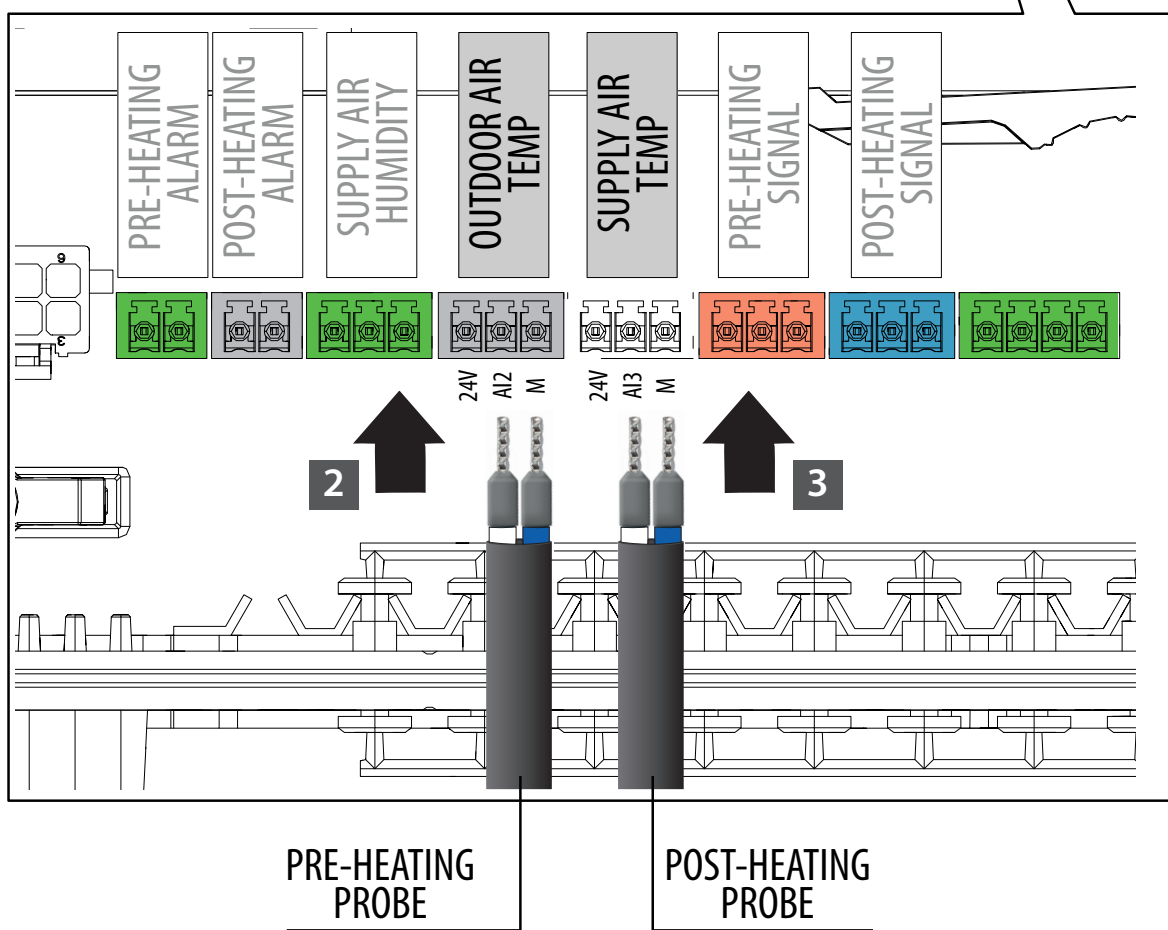
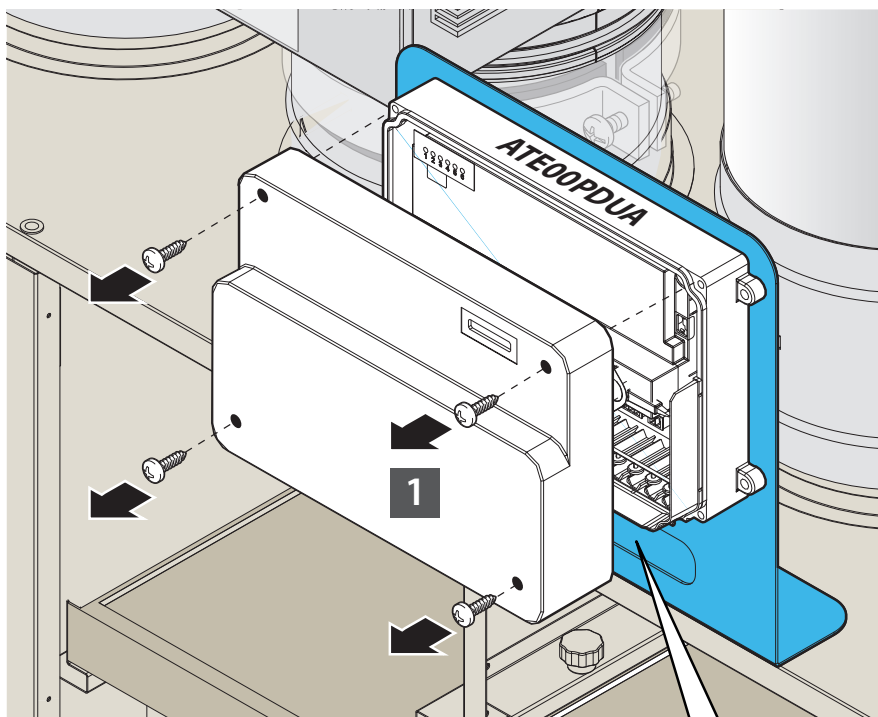

## 10 Connection of probe (PRE/POST-HEATING)

## Connection of PRE-HEATING probe

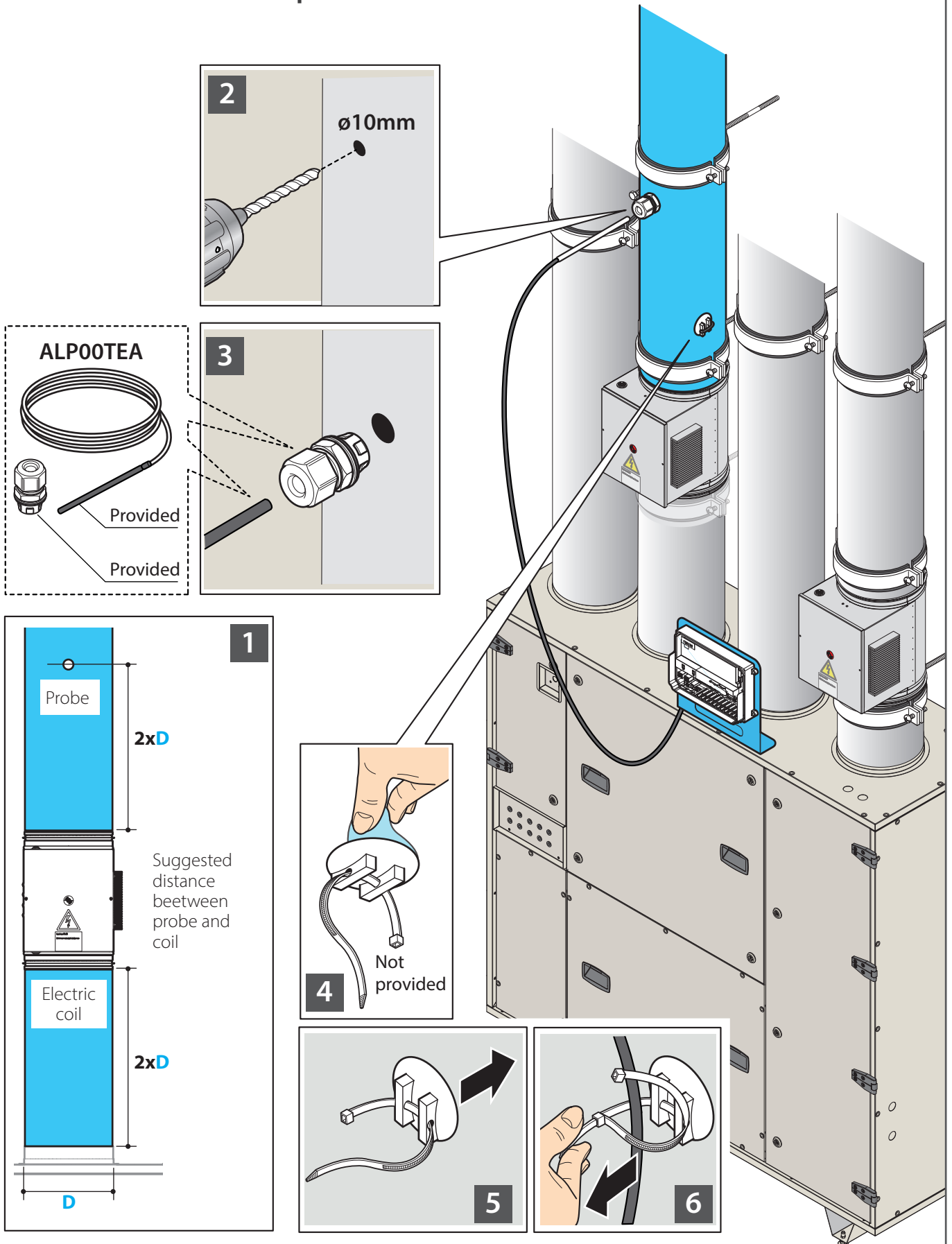

### 11 Installation of probe (PRE-HEATING)

## Connection of POST-HEATING probe

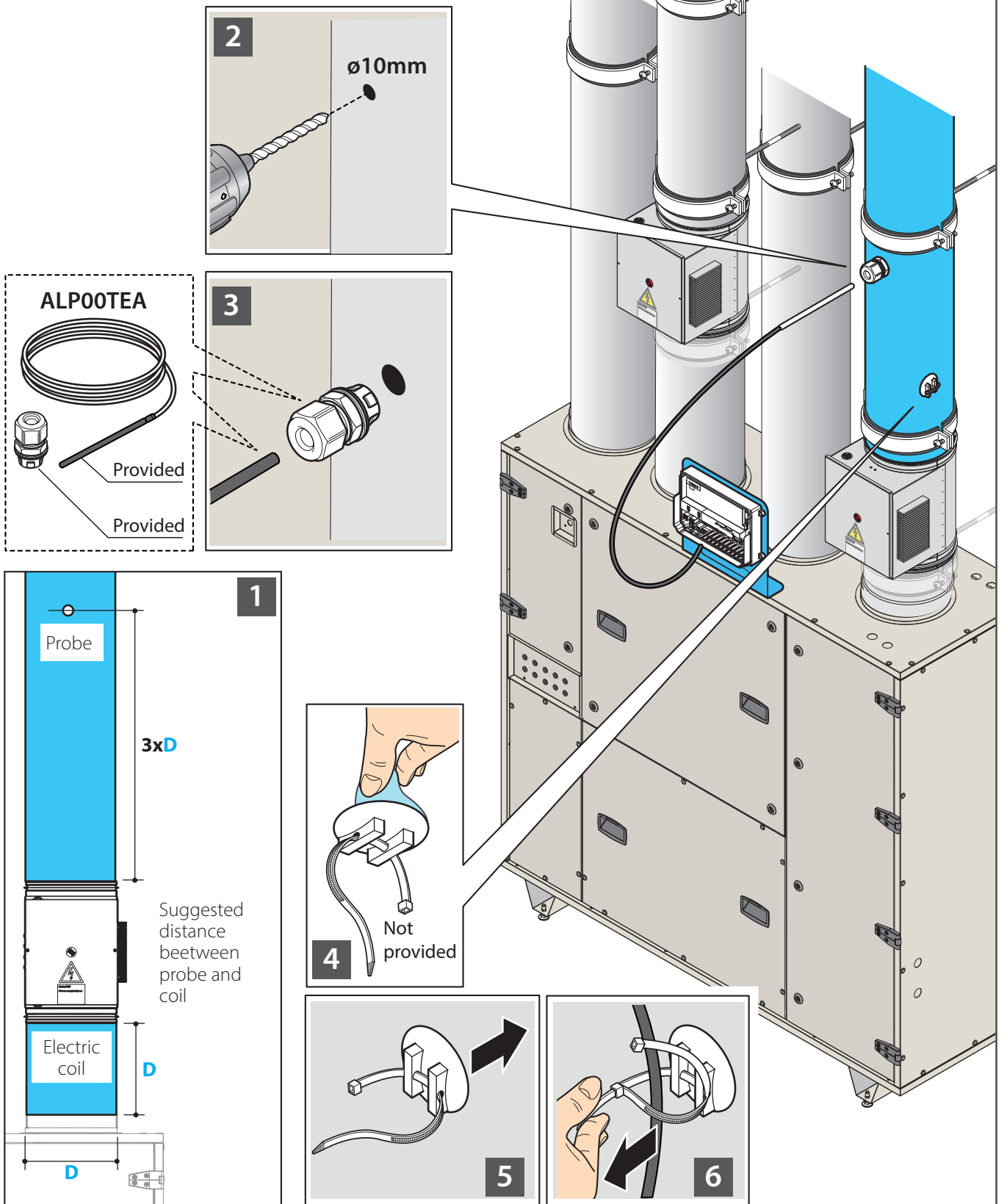

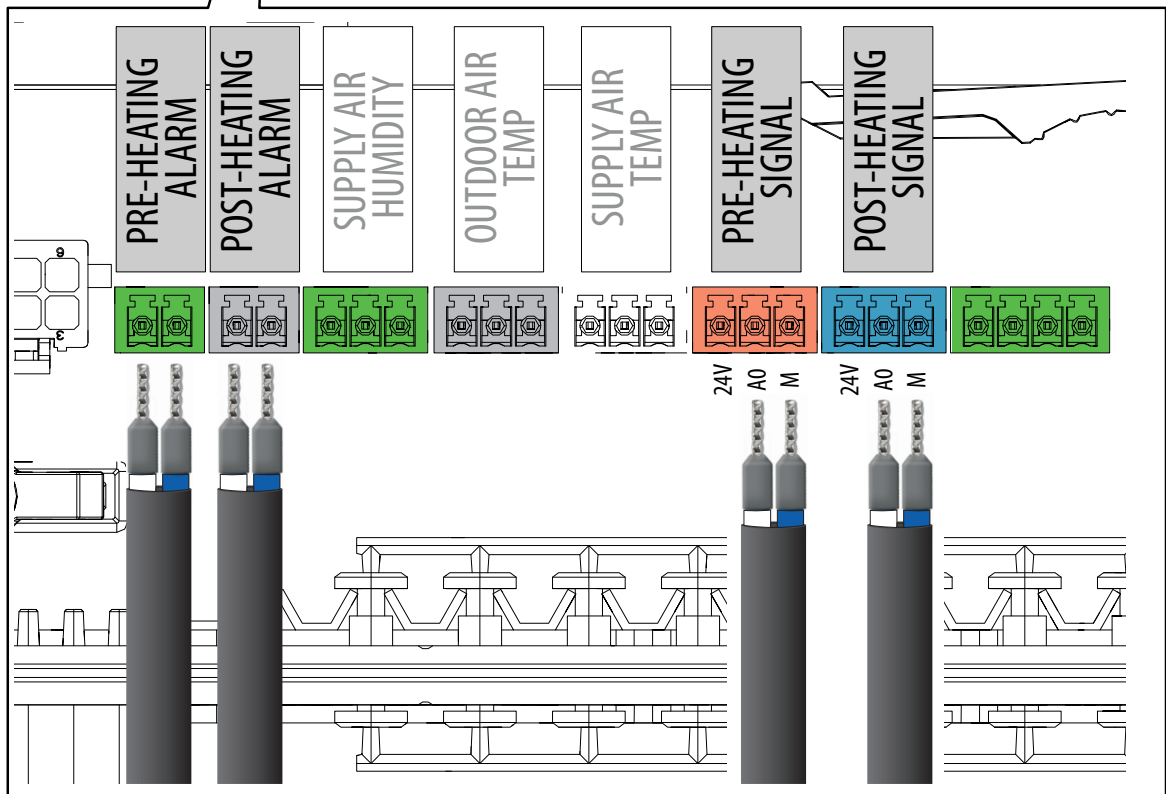
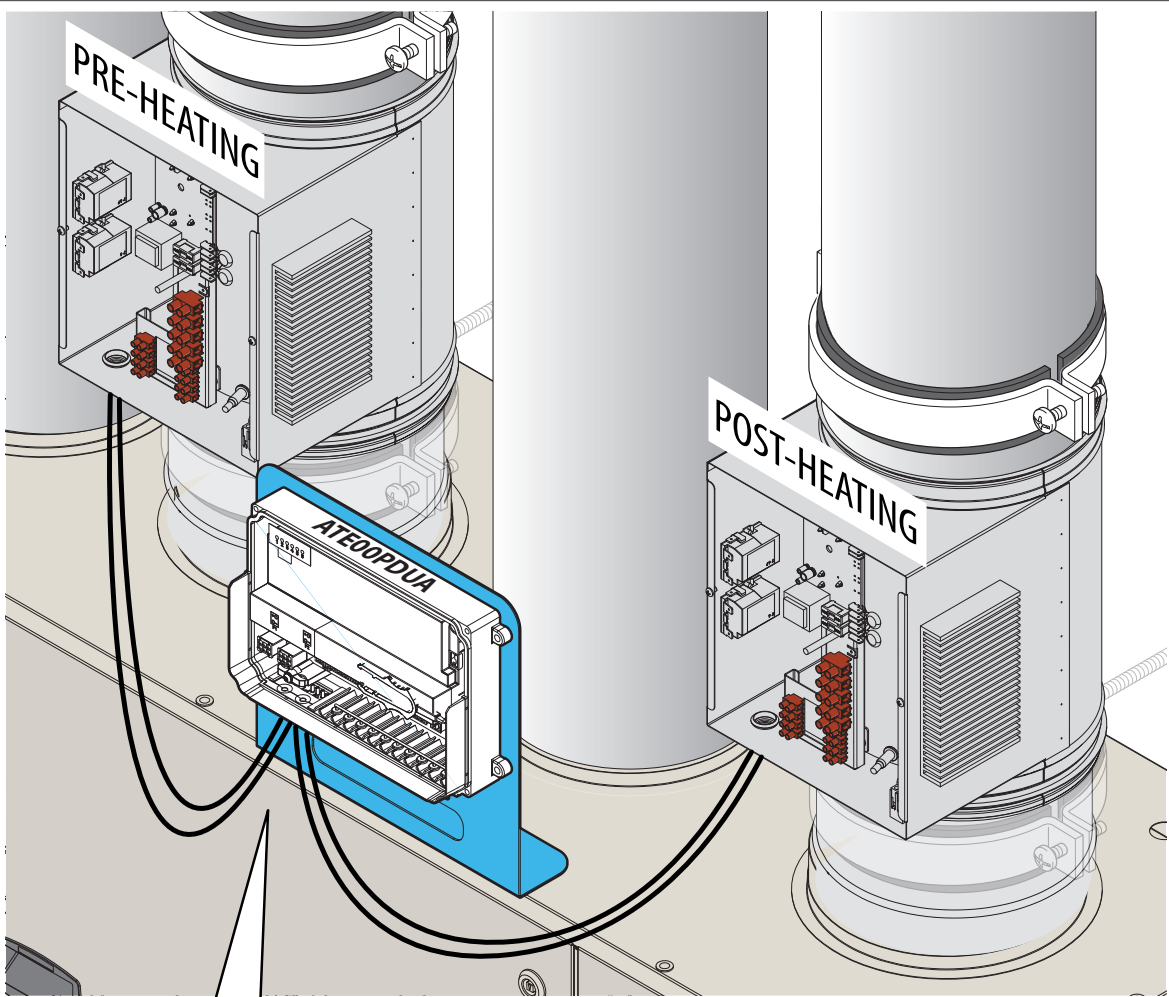

### 13 Connection of alarm and signal cables

# Software setup (PRE HEATING)

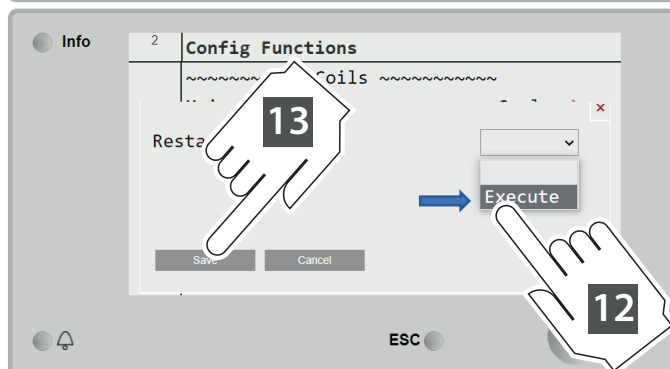
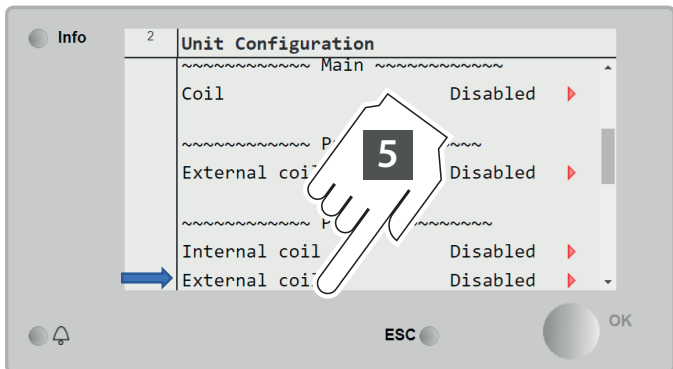
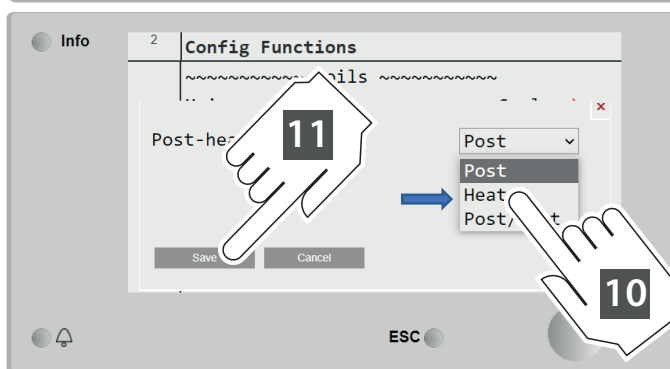
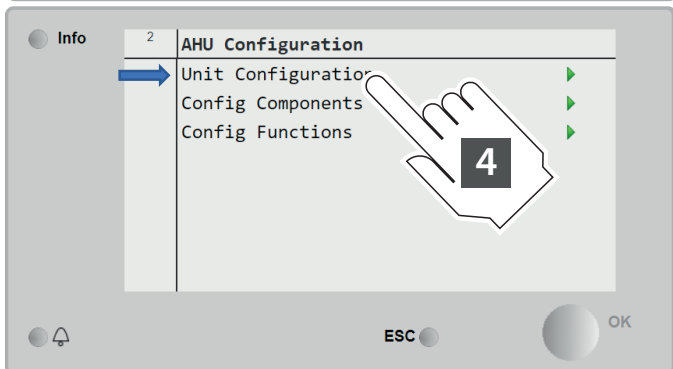
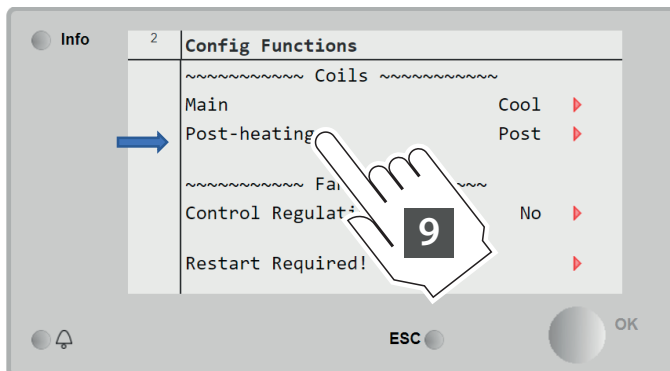
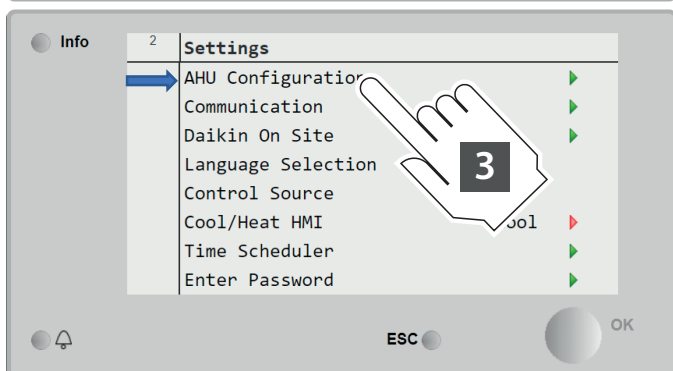
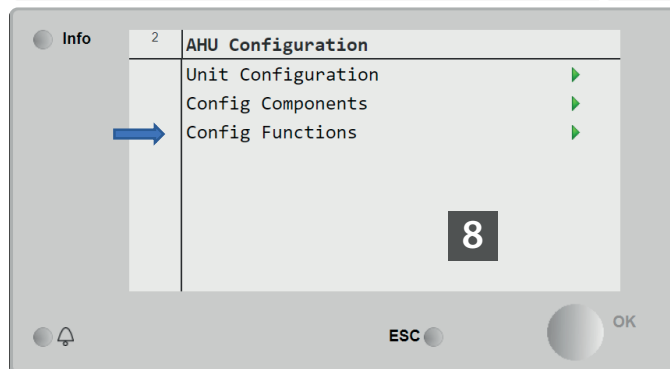
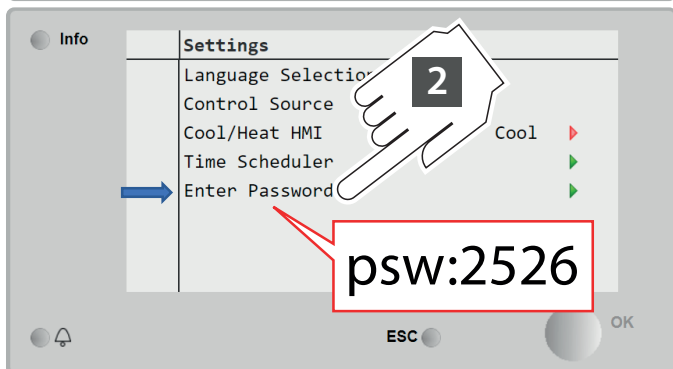
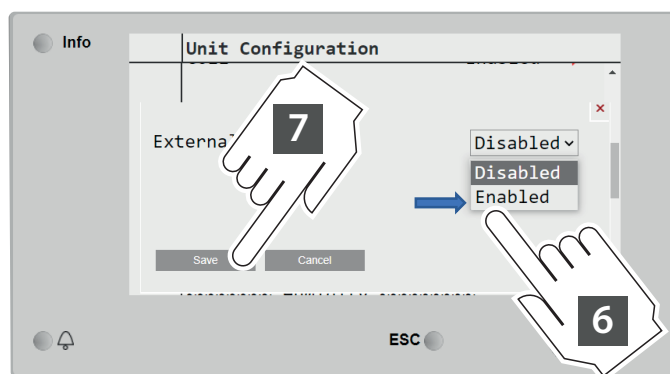
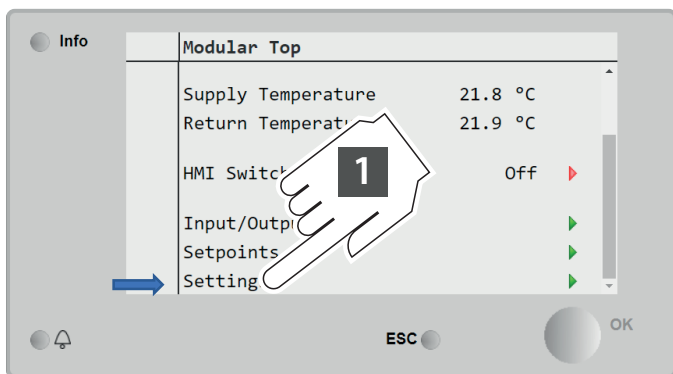

# Software setup (POST HEATING)

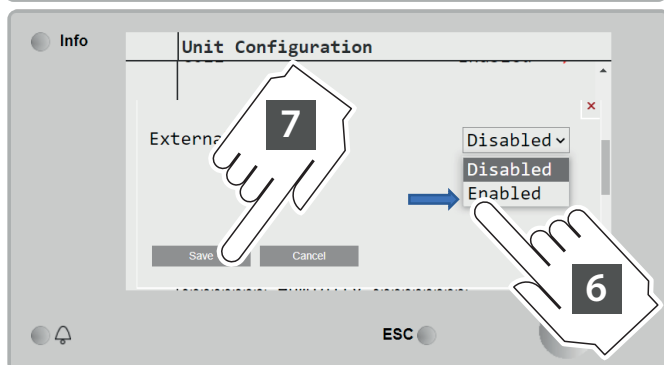
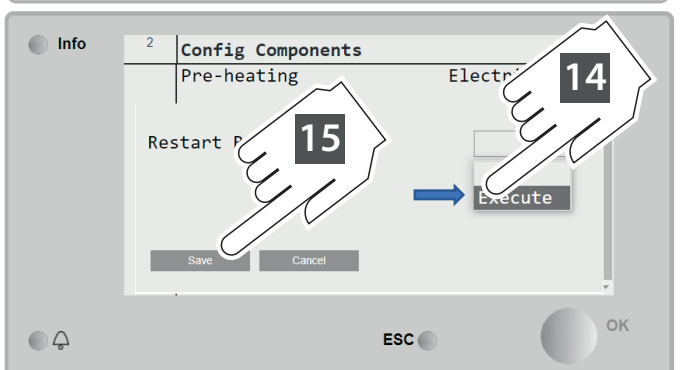
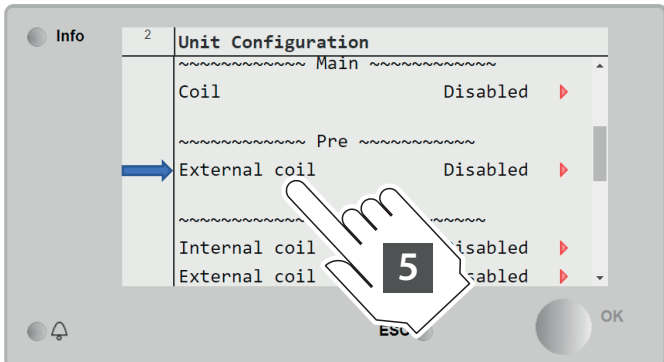
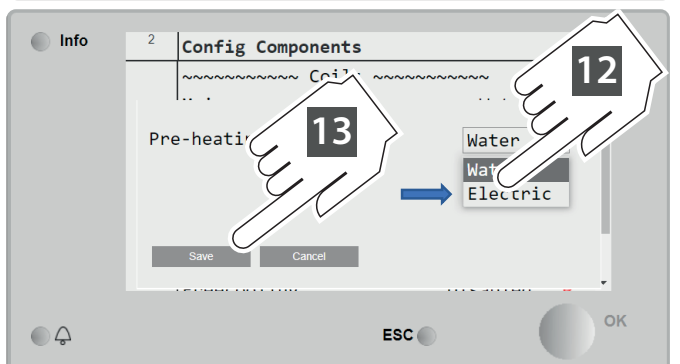
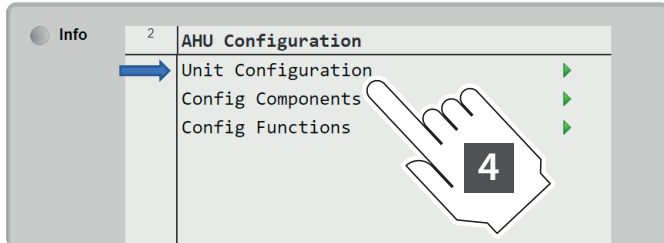
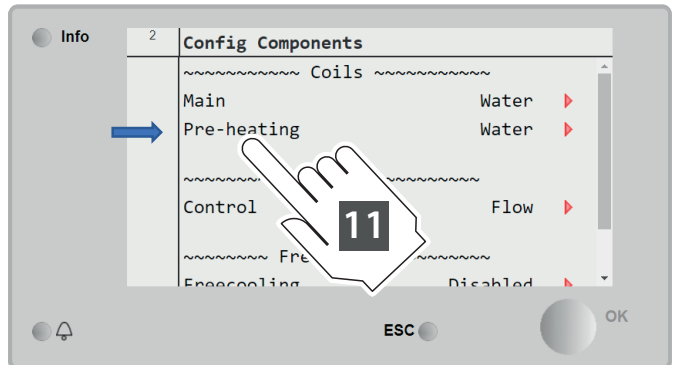
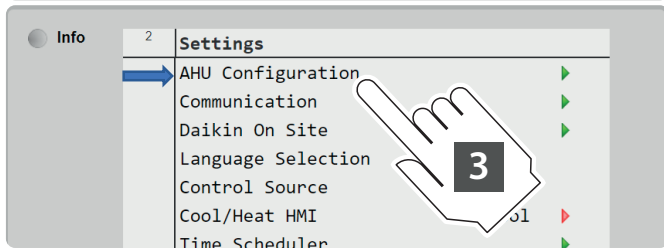
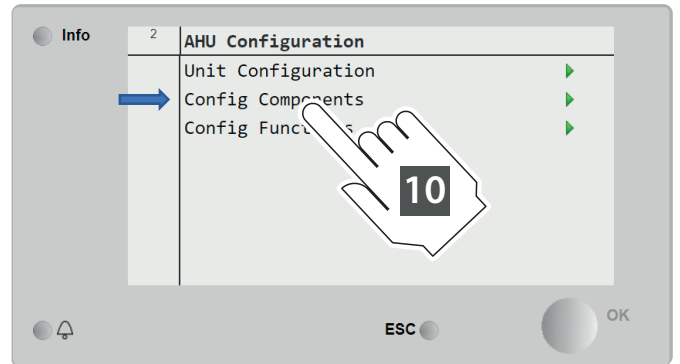
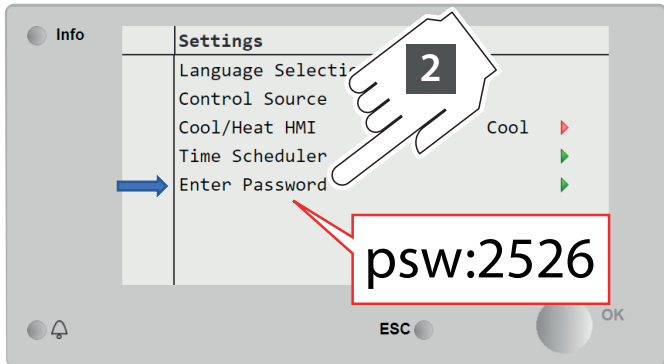
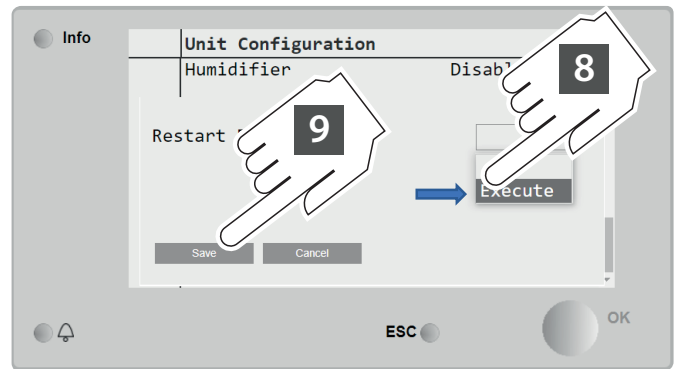
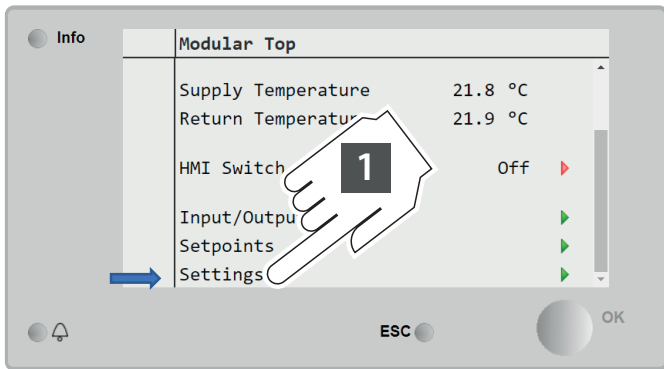





For more information email [info@daikinapplied.uk](mailto:info@daikinapplied.uk) or visit [www.daikinapplied.uk](http://www.daikinapplied.uk)

For all Daikin Applied UK,  
Daikin Applied Service &  
Spares enquiries call us on:  
**0345 565 2700**



Daikin Europe N.V. participates in the Eurovent Certified Performance programme for Liquid Chilling Packages and Hydronic Heat Pumps, Fan Coil Units and Variable Refrigerant Flow systems. Check ongoing validity of certificate:  
[www.eurovent-certification.com](http://www.eurovent-certification.com)

The present publication is drawn up by way of information only and does not constitute an offer binding upon Daikin Europe N.V. Daikin Europe N.V. has compiled the content of this publication to the best of its knowledge. No express or implied warranty is given for the completeness, accuracy, reliability or fitness for particular purpose of its content and the products and services presented therein. Specifications are subject to change without prior notice. Daikin Europe N.V. explicitly rejects any liability for any direct or indirect damage, in the broadest sense, arising from or related to the use and/or interpretation of this publication. All content is copyrighted by Daikin Europe N.V.

