



Installation manual

Electric pre/post heating Compact T

D-EIMOC2009-22_01EN

› Compact T

Original translations

REV	01
DATE	October 2024
REPLACES	D-EIMOC2009-22_00EN

1 Important warnings



The pictogram shows a situation of immediate danger or a dangerous situation that might cause injuries or death.



The pictogram shows that it is necessary to adopt suitable behaviour in order to avoid jeopardising staff safety and cause damages to the equipment.



The pictogram shows particularly important technical information that should be taken into consideration by the people installing or using the equipment.



Read this manual carefully before installation and keep it for any further future consultation by the various operators. Do not remove, tear out or rewrite any part of this manual.



Failure to follow these instructions may cause damage and injuries, even fatal, voids the warranty and relieves the Manufacturer of any liability.



All installation, assembly, electrical connections to the mains and ordinary/extraordinary maintenance must be performed **only by technicians complying with the legal requirements**, after turning off the unit and using personal protective equipment (i.e. gloves, protective goggles, etc.), in compliance with the regulations in force in the country the equipment is to be used in and the laws on safety in the workplace.



Installation, use or maintenance other than those specified in the manual may cause damage, injury or death, invalidate the warranty and relieve the Manufacturer of all liability.



Use protective clothing and suitable equipment while handling or installing the equipment, in order to prevent accidents and safeguard your own and other people's safety. Individuals not assigned to installation or maintenance are NOT allowed to stand or pass through the work area while the unit is assembled.



Before carrying out any installation, disconnect the equipment from the power supply and wait at least 120 seconds before carrying out any operation.



It is the responsibility of the user/installer to check the static and dynamic stability relative to the installation and to arrange environments so that **people who are not competent or authorised DO NOT have access to the unit or to its controls.**

2 Technical data

Compact T PRO

Size	Material name	Load kW	A mm	B mm	C mm	D mm	Weight kg	Supply voltage
03	ATD03HEFAU	12	518	416	71	250	8,6	3-phase; 400V
	ATD03HESAU	4.5	389	290	71	250	5.8	3-phase; 400V
04	ATD04HEFAU	15	651	548	71	315	15.4	3-phase; 400V
	ATD04HESAU	6	393	291	71	315	8.7	3-phase; 400V
05	ATD05HEFAU	18	651	548	72	355	17.4	3-phase; 400V
	ATD05HESAU	6	389	287	72	355	9.4	3-phase; 400V
06	ATD06HEFAU	21	774	672	71	400	22.3	3-phase; 400V
	ATD06HESAU	7.2	389	286	71	400	10.5	3-phase; 400V
07	ATD07HEFAU	24	902	800	71	500	29.4	3-phase; 400V
	ATD07HESAU	8.4	518	416	71	500	15.1	3-phase; 400V

Compact T SMART

Size	Material name	Load kW	A mm	B mm	C mm	D mm	Weight kg	Supply voltage
03	ATD03HEFBU	12	518	416	71	250	8,4	3-phase; 400V
04	ATD04HEFBU	15	651	548	71	315	15.2	3-phase; 400V
05	ATD05HEFBU	18	651	548	72	355	17.2	3-phase; 400V
06	ATD06HEFBU	21	774	672	71	400	22	3-phase; 400V
07	ATD07HEFBU	24	902	800	71	500	29.2	3-phase ; 400V

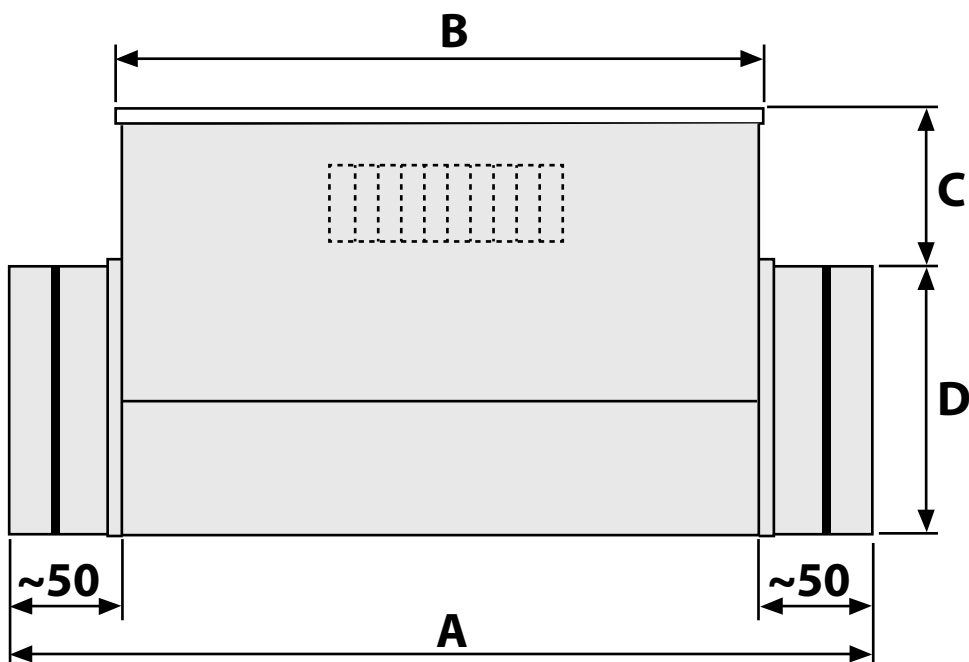

COMPACT T PRO

COMPACT T SMART

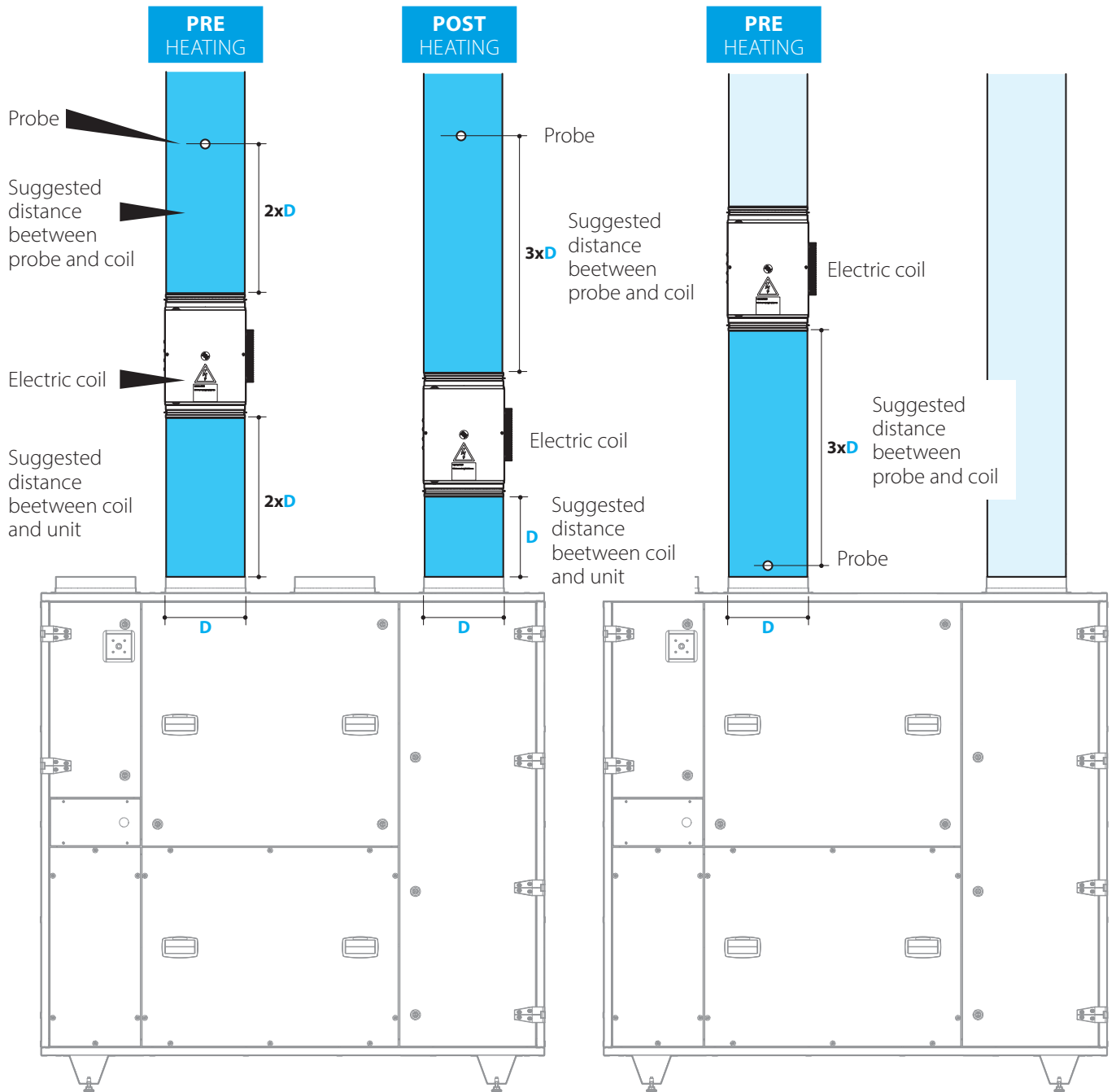

D^* = diameter of ducts

(e.g. if $D = 250 \text{ mm}$ $\rightarrow 1xD = 250 \text{ mm}$, $2xD = 500 \text{ mm}$...)

1 Correct distance

3 Installation

COMPACT T PRO

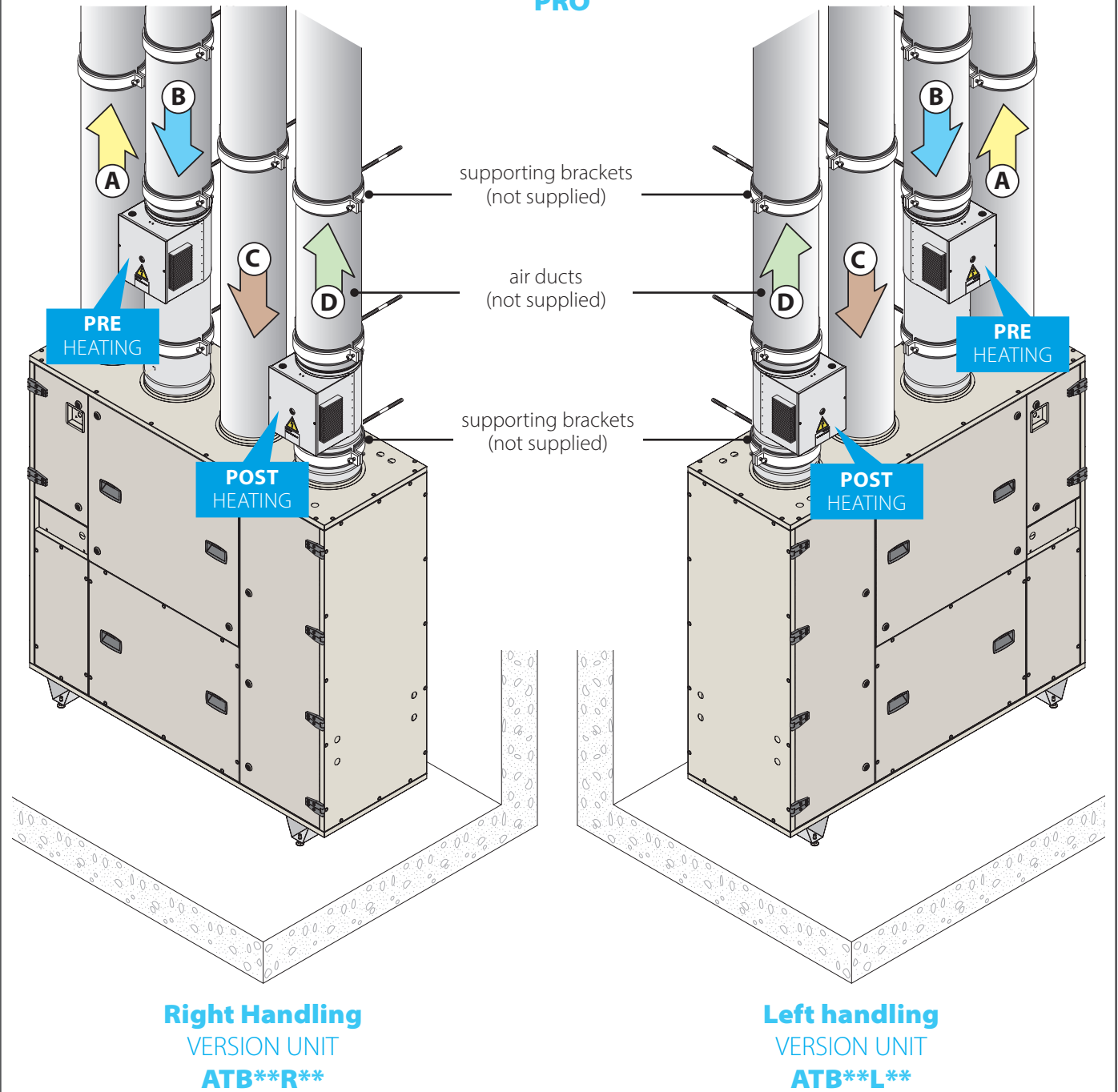

DUCT

- A** Exhaust air
- B** Fresh air
- C** Return air
- D** Supply air

2 Unit duct, example

COMPACT T
SMART

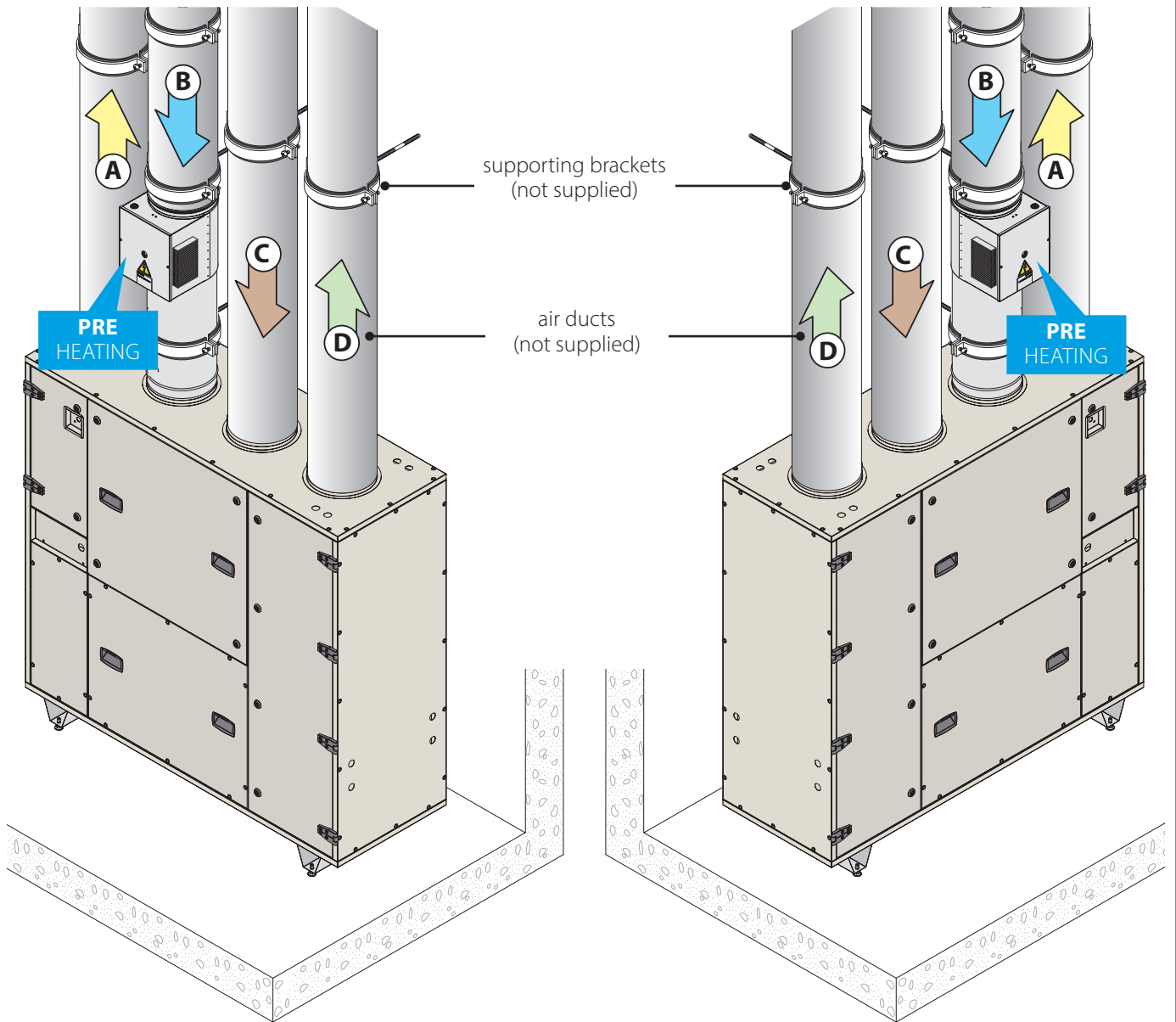

Right Handling
VERSION UNIT
ATBR****

Left handling
VERSION UNIT
ATBL****

DUCT

- A** Exhaust air
- B** Fresh air
- C** Return air
- D** Supply air

4 Unit duct, example

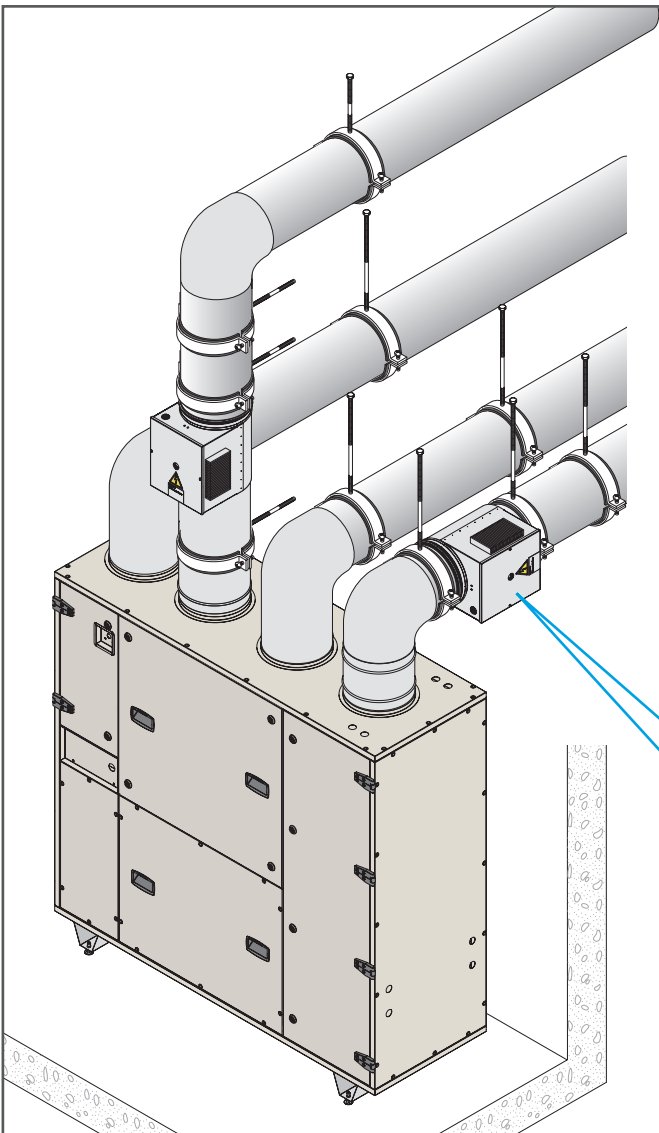

Electric post/pre heating coil can be positioned both **horizontally** and **vertically**. The ducts and the electric coils must be **permanently fixed to a fixed structure** (for example a wall or a ceiling) using brackets (not supplied). Electric post/pre heating coil should be installed in such a way that it is accessible for maintenance or any other operation. **The electric post/pre heating coil should not be facing down.**



Provide thermal insulation (not supplied) around the electric coils because they reach high temperatures (<60 °C).

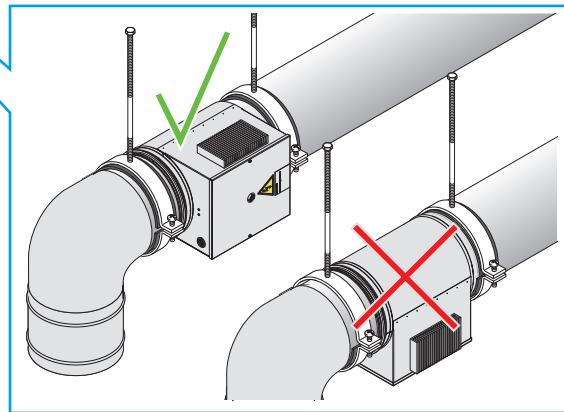

5 Example of installation of the electric post/pre heating both horizontally and vertically

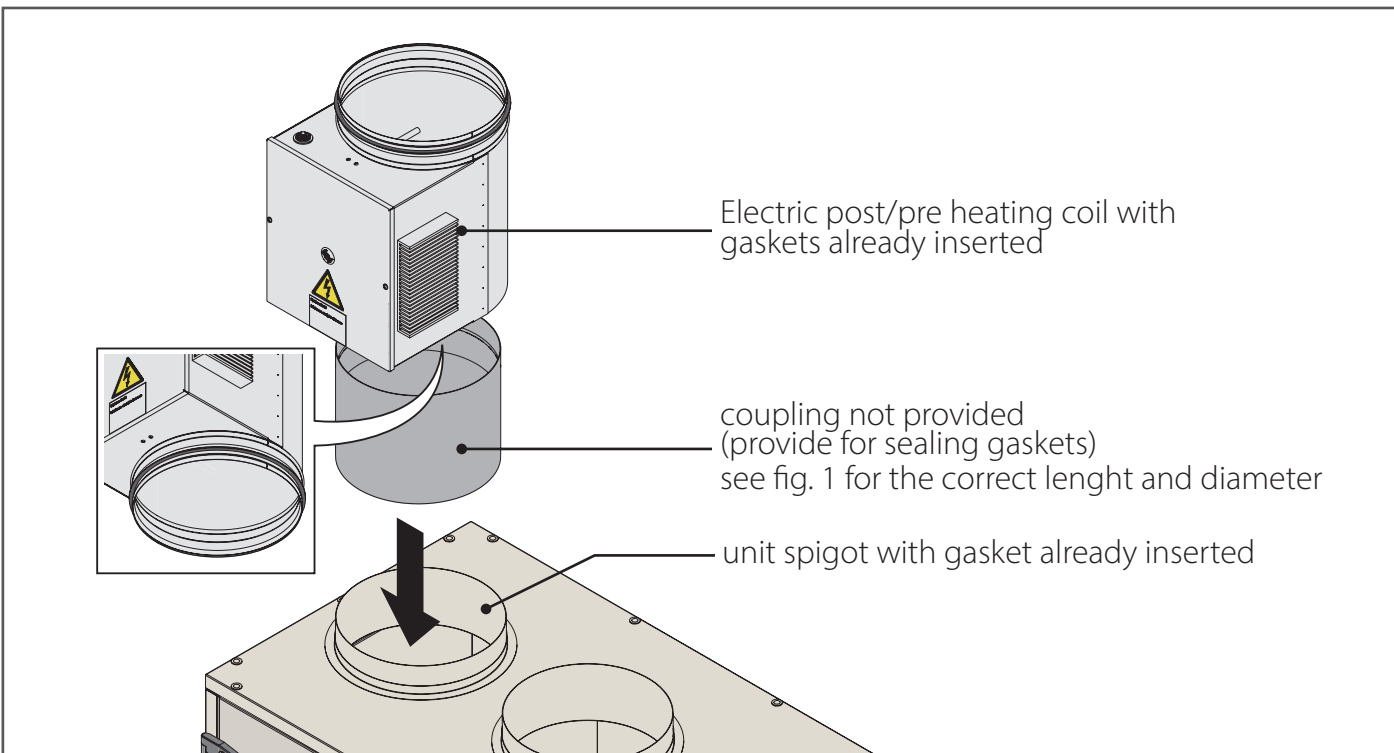

6 Installation of electric pre/post heating

4 Electrical connections

Power supply

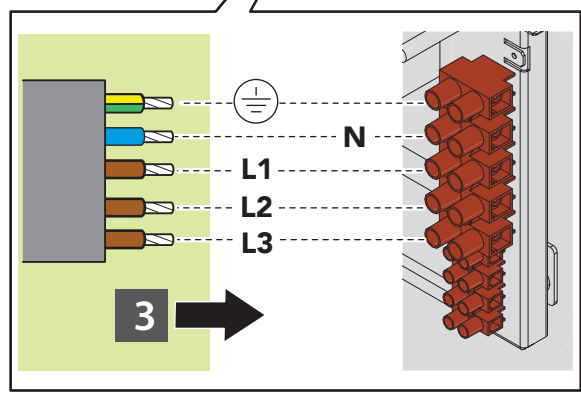
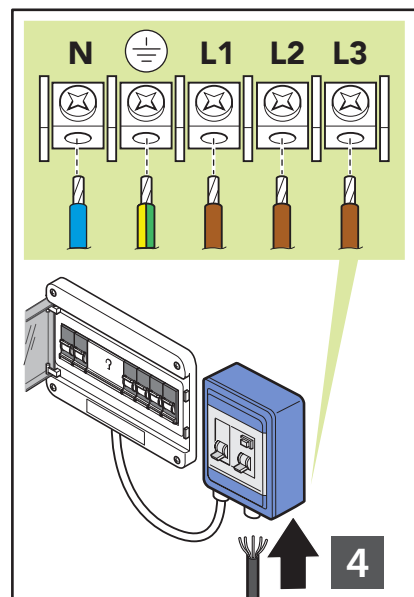
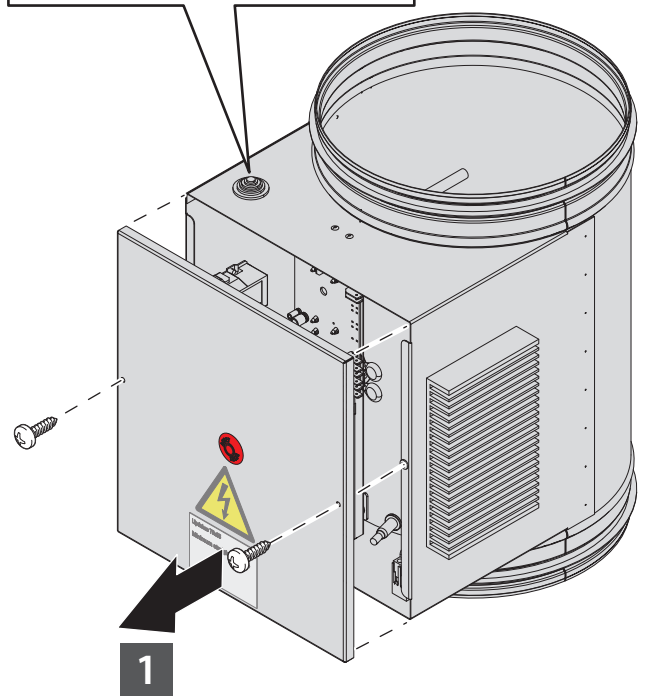
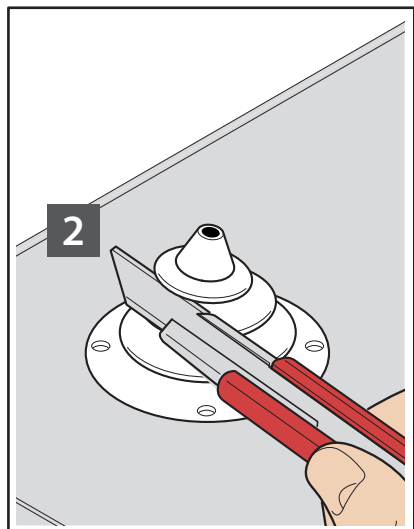

Compact T Smart version only

Connection of PRE-HEATING probe

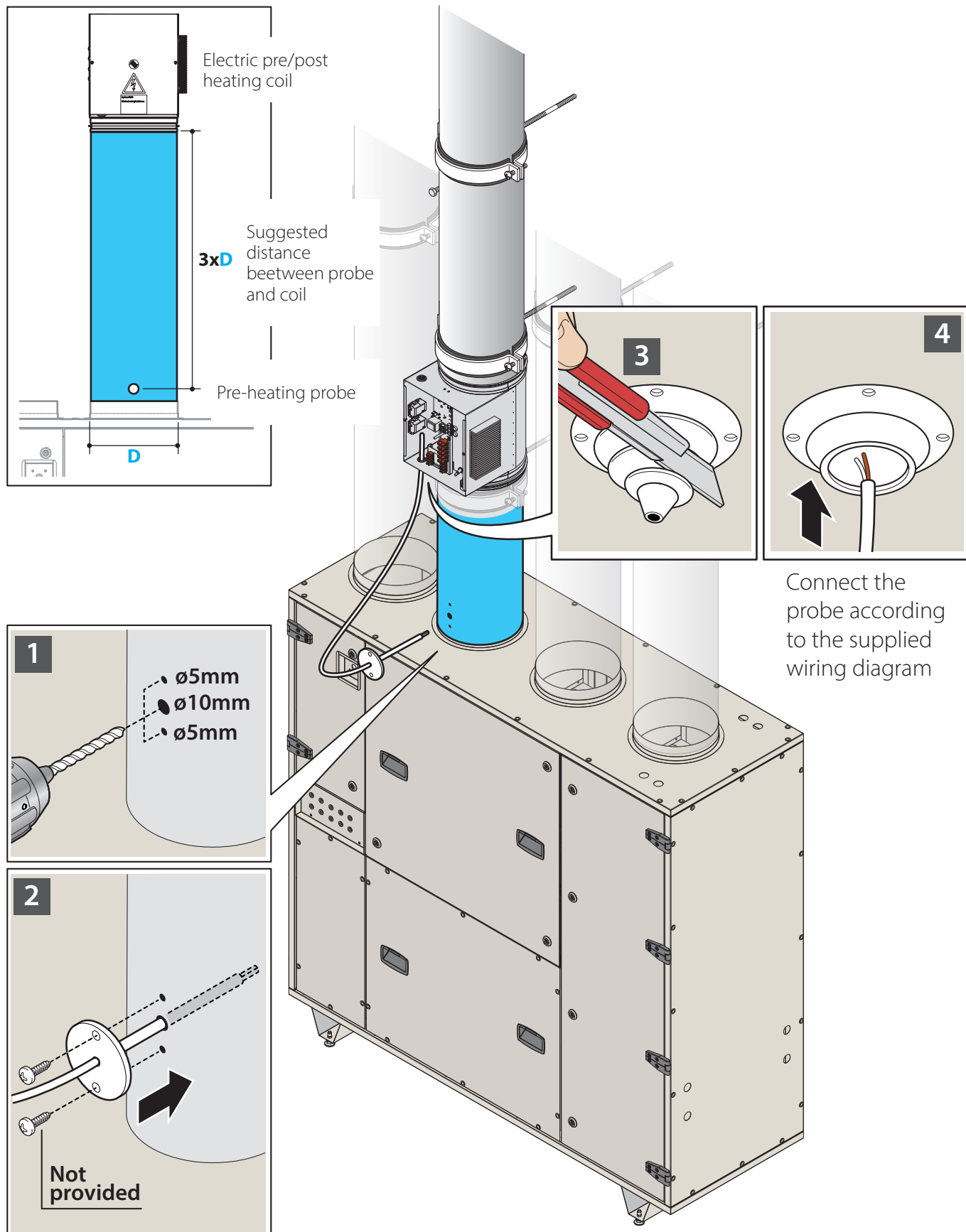

Potentiometer

set the target temperature

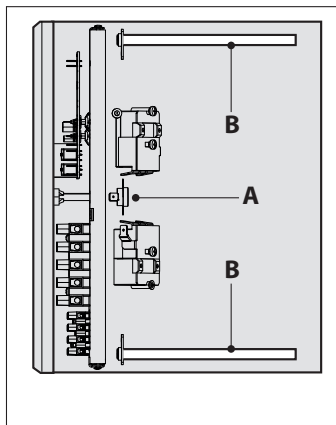
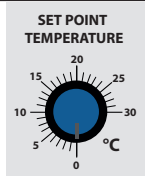

Reset button

the electric coils have 3 safety thermostats that intervene in case of high temperature; the thermostats (B) are set at 50 °C and are self-resetting, while the thermostat (A) is set at 100 °C and must be manually reset by pushing the reset button

The electric coil has an alarm contact that may be used to trigger a warning system (not provided).

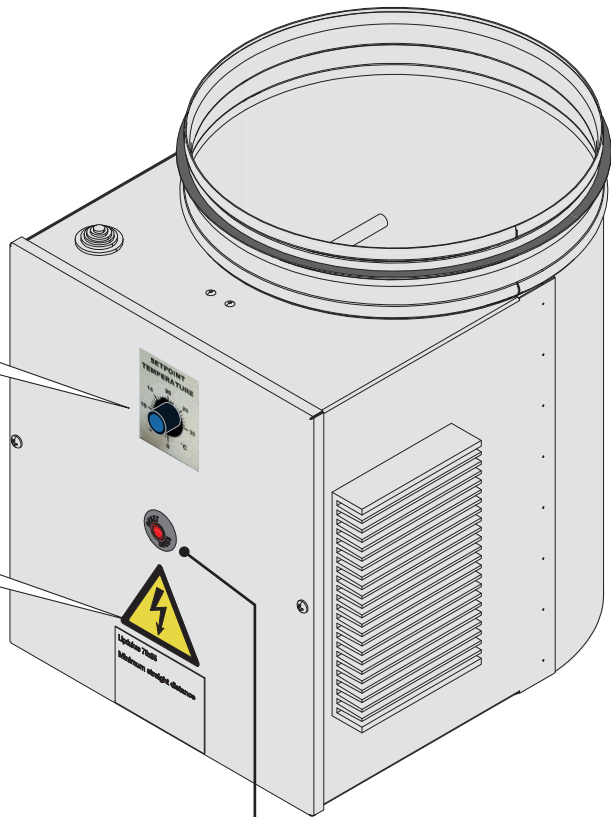

Compact T Pro version only

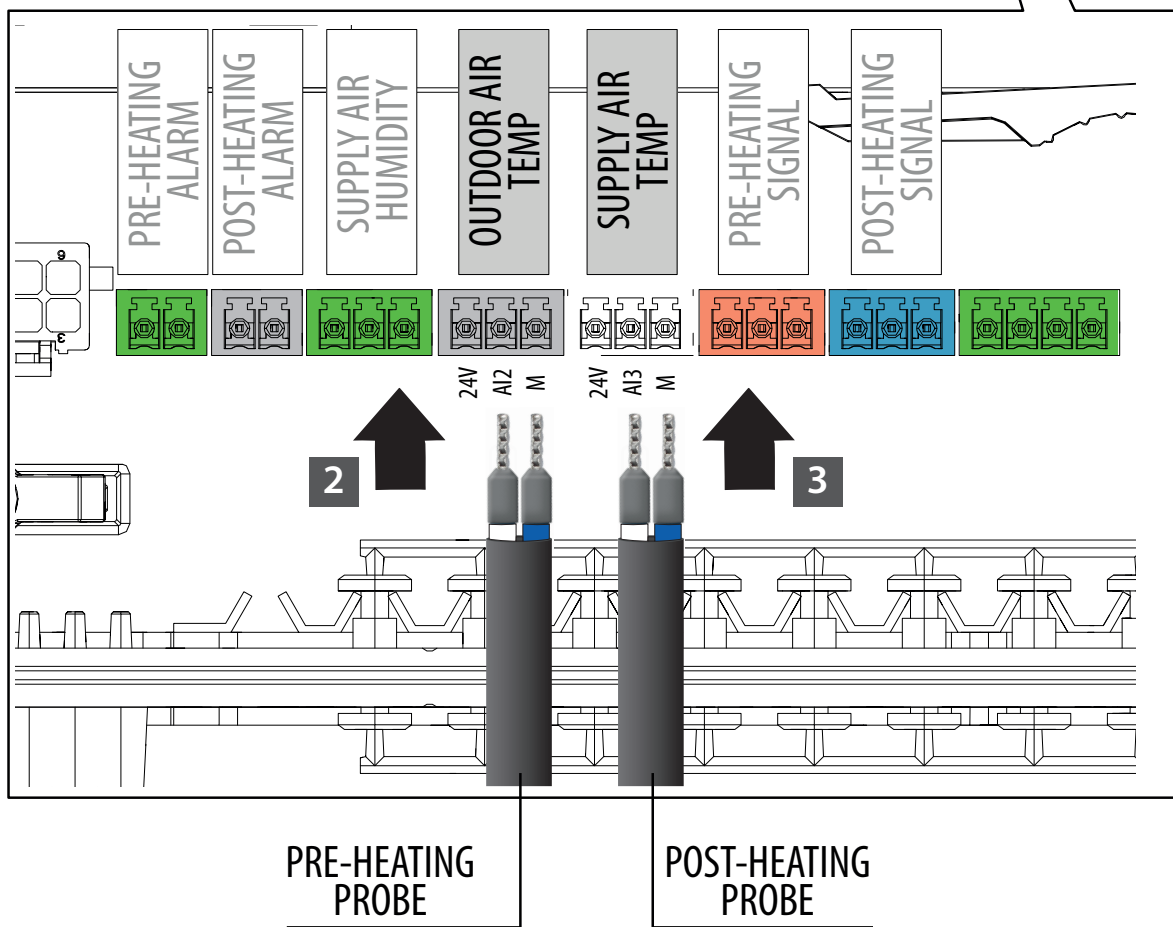
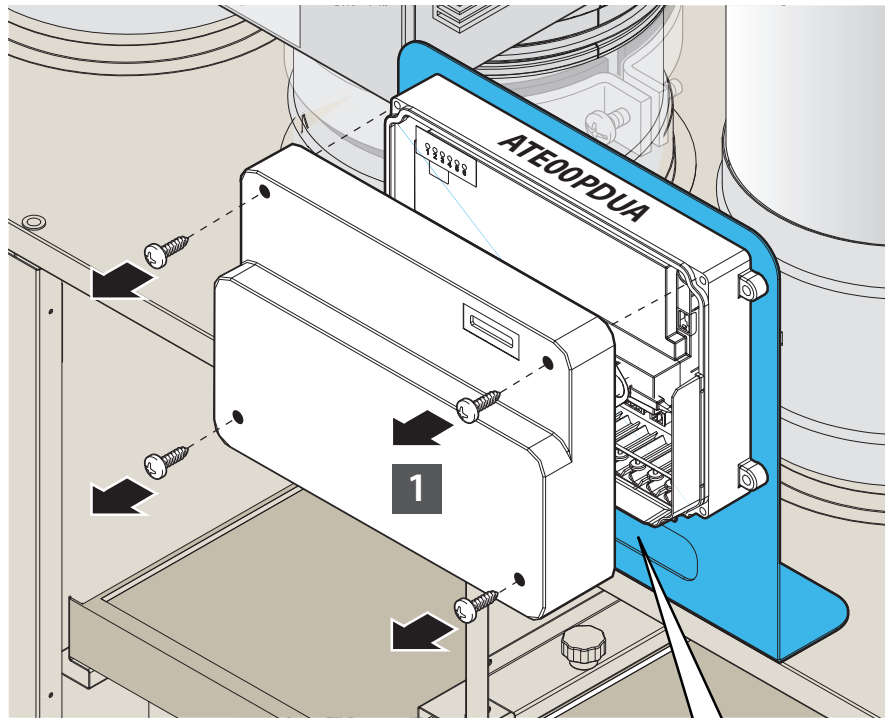

10 Connection of probe (PRE/POST-HEATING)

Connection of PRE-HEATING probe

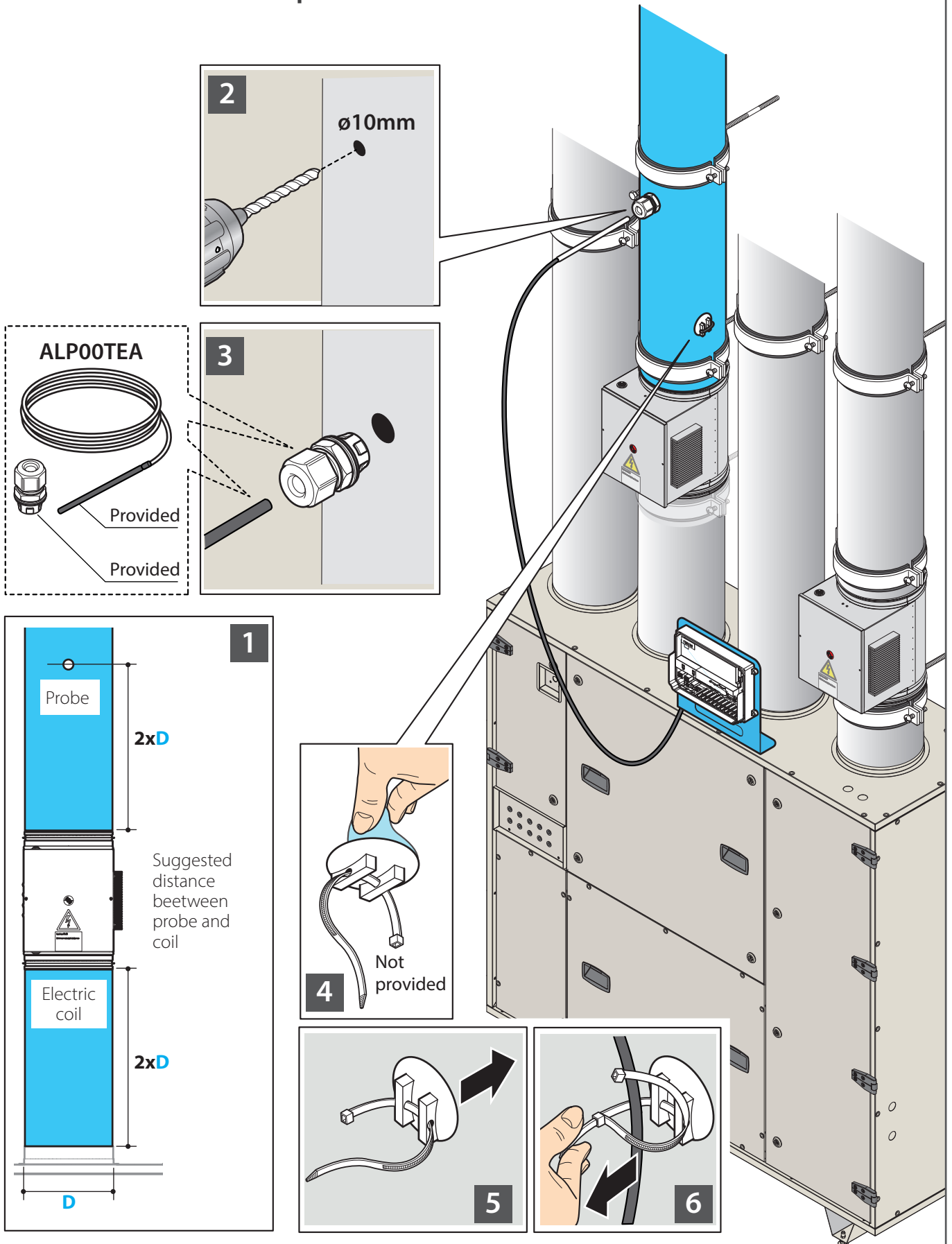

11 Installation of probe (PRE-HEATING)

Connection of POST-HEATING probe

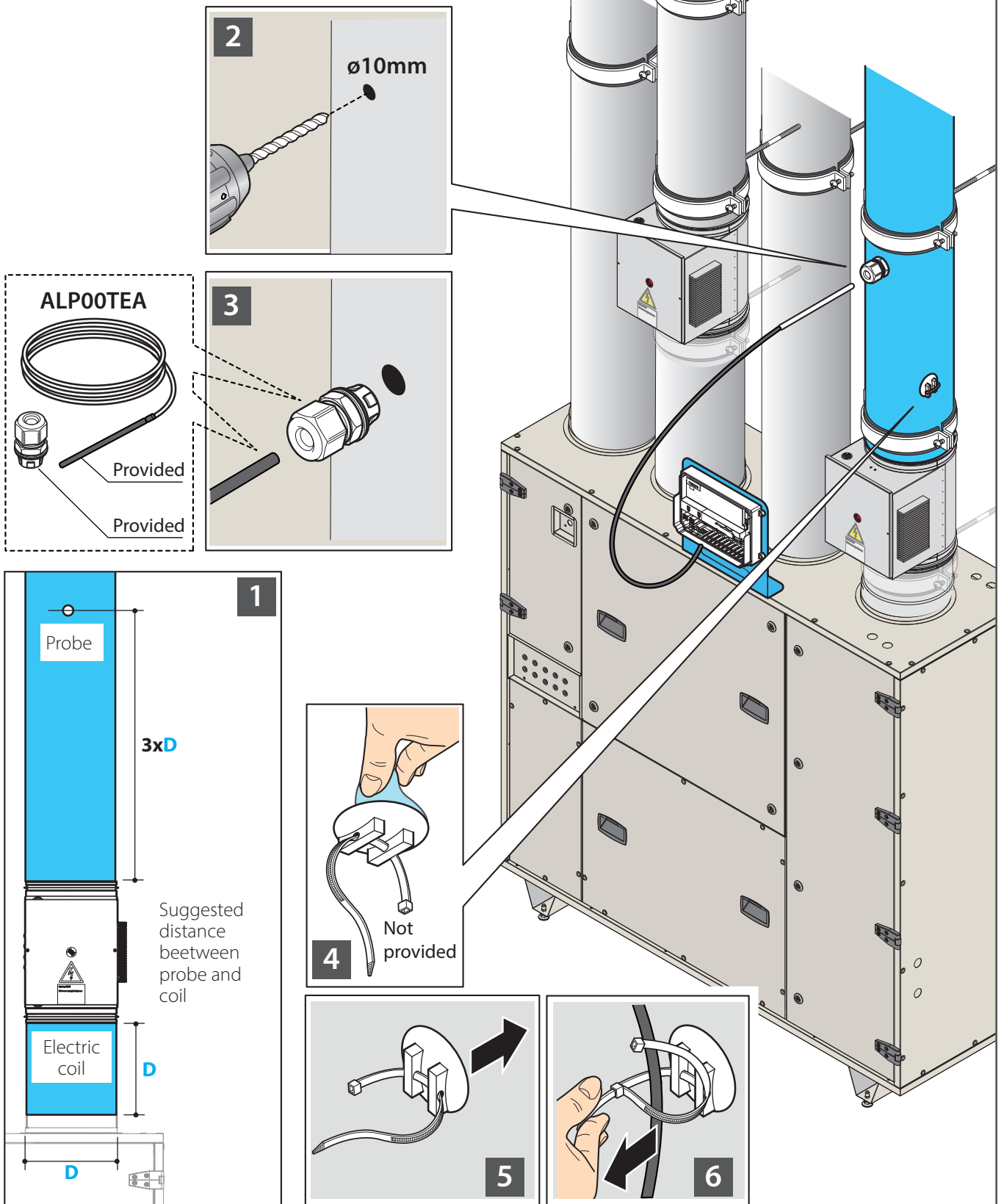

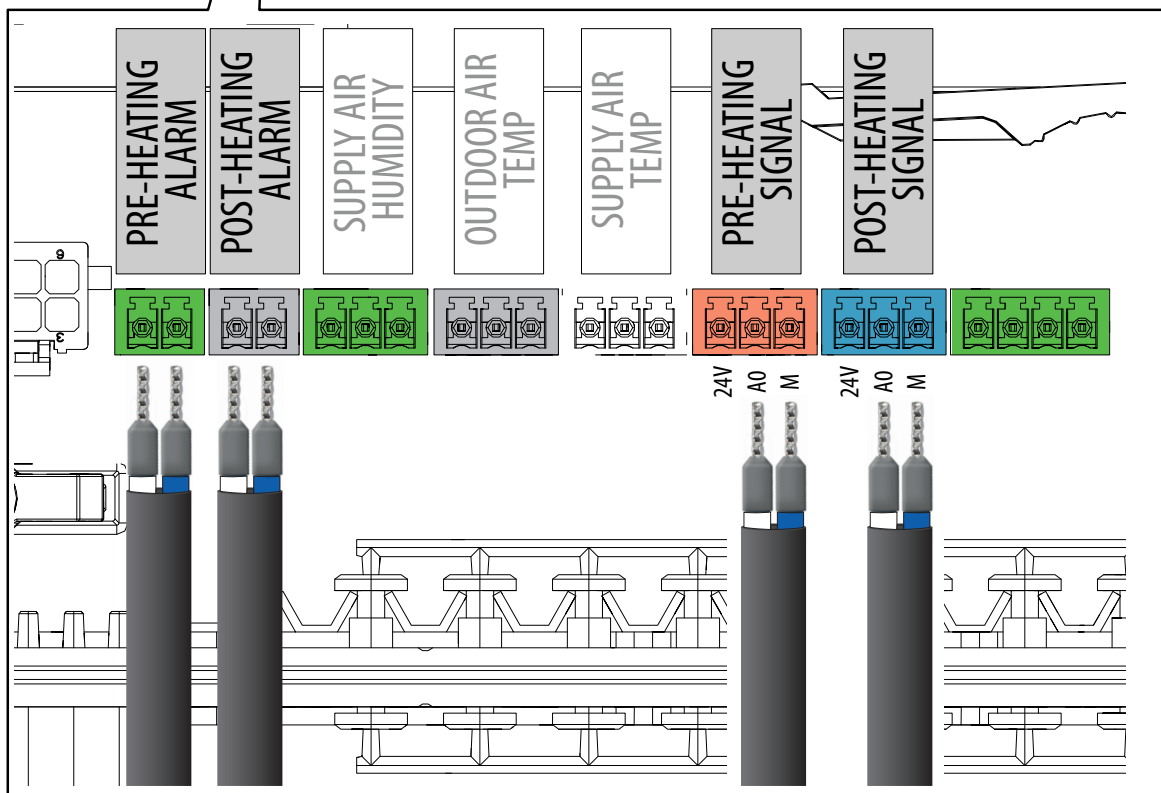
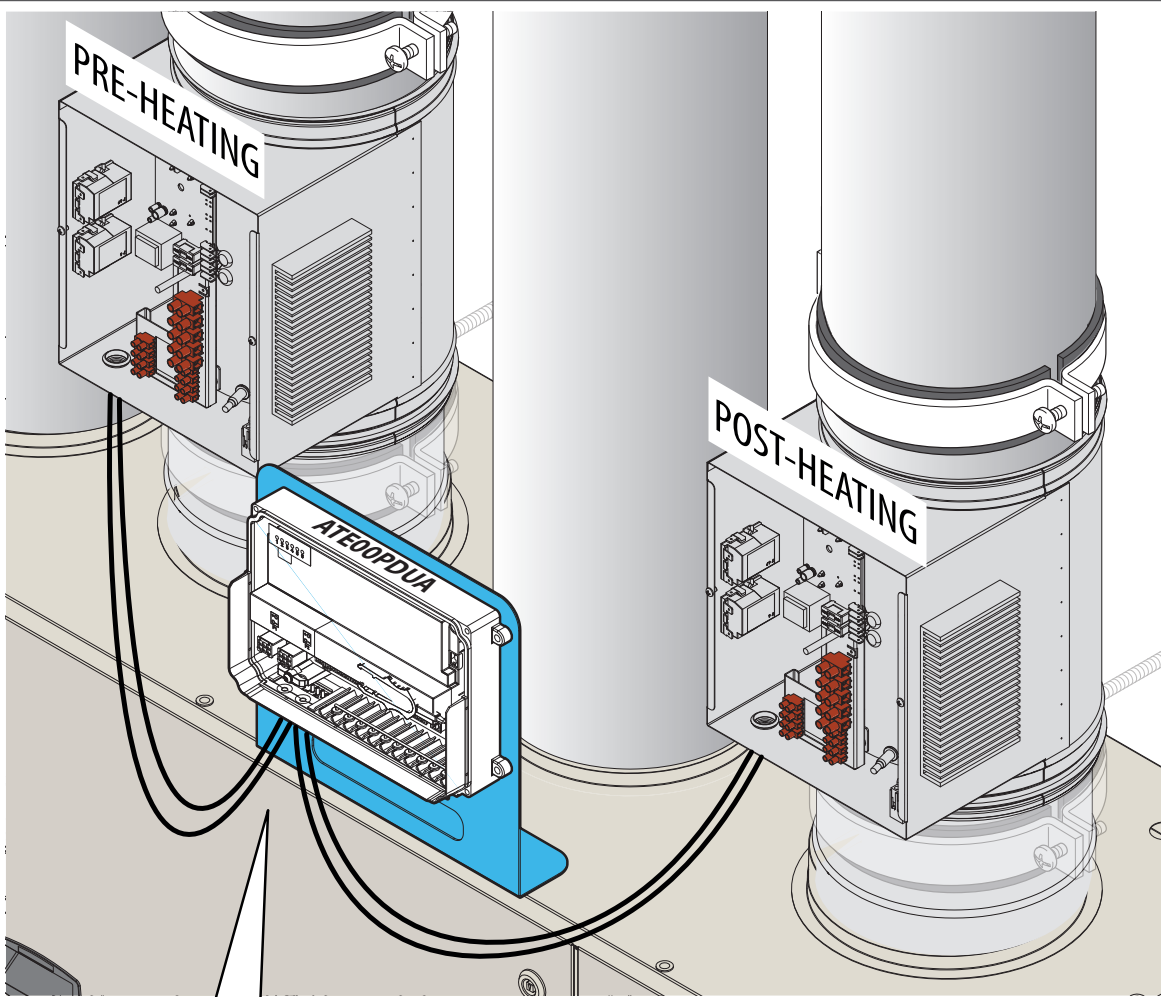

13 Connection of alarm and signal cables

Software setup (POST HEATING)

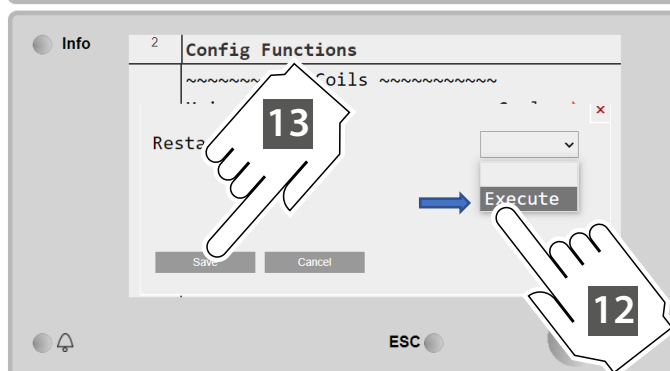
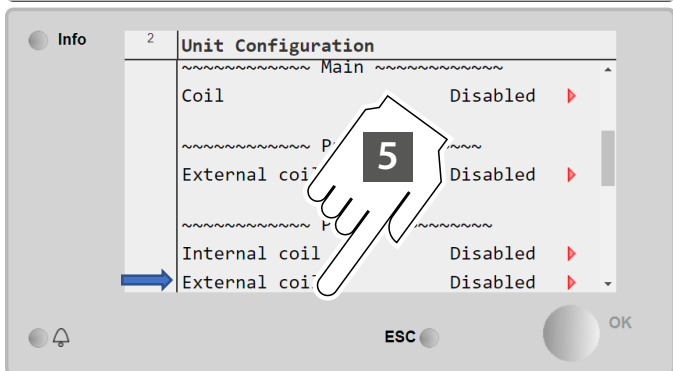
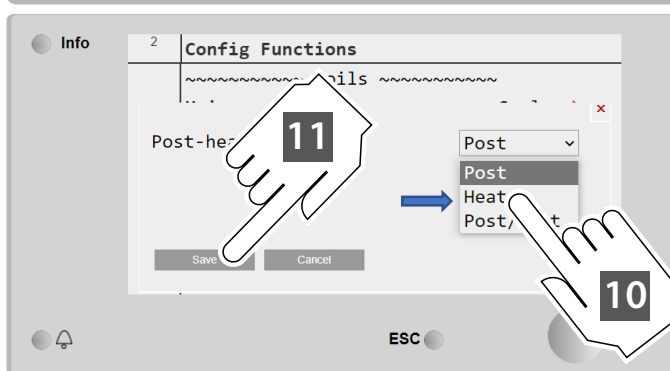
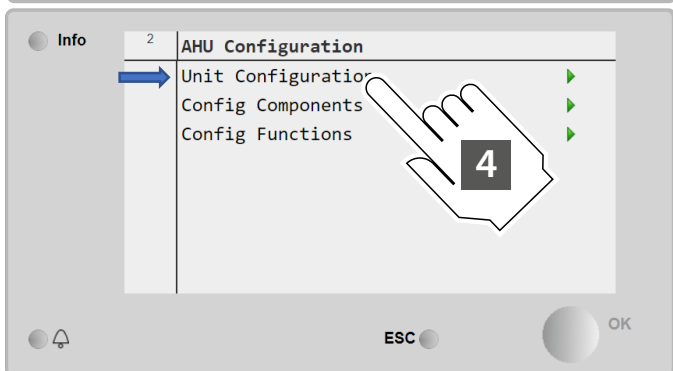
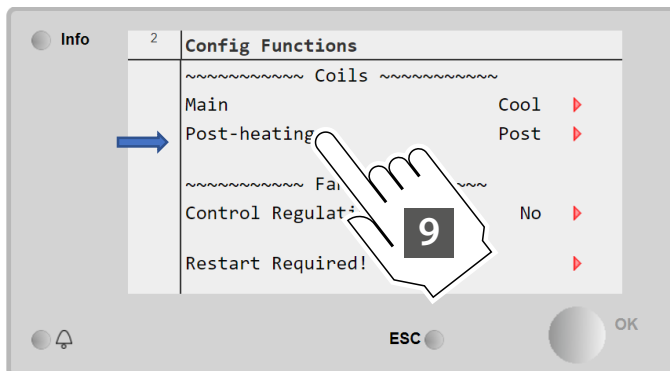
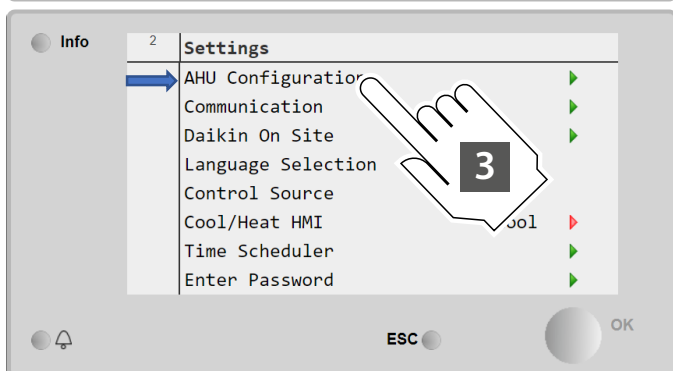
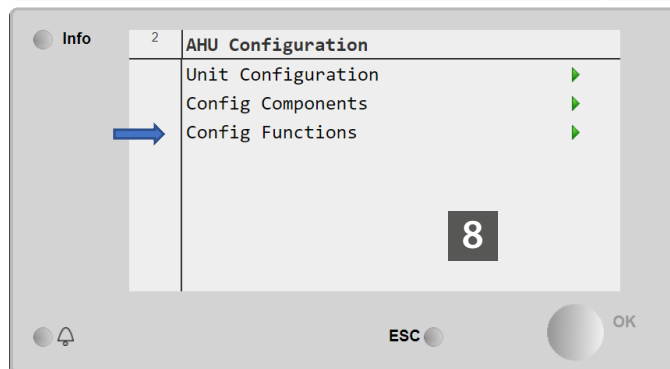
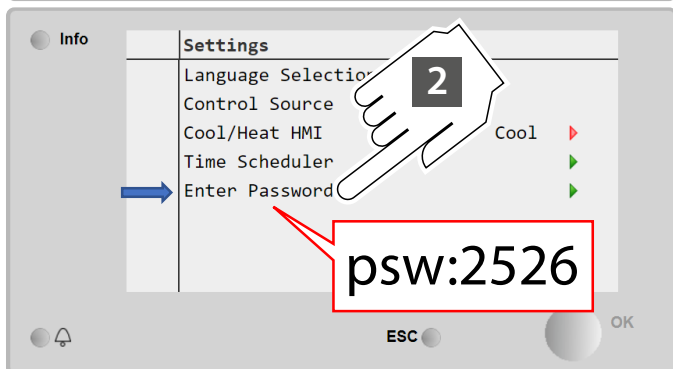
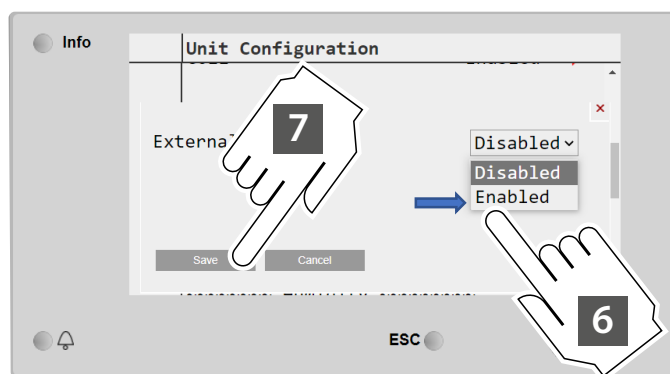
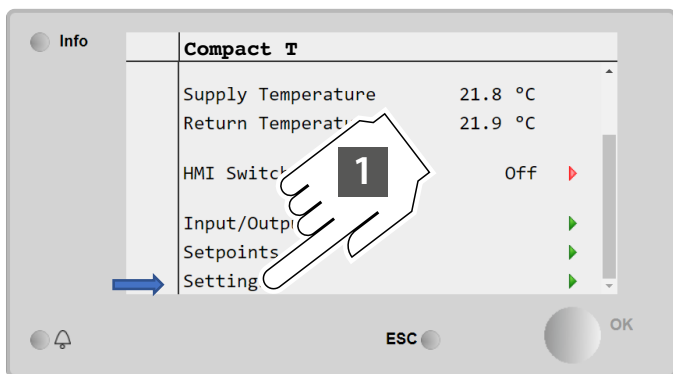

Software setup (PRE HEATING)

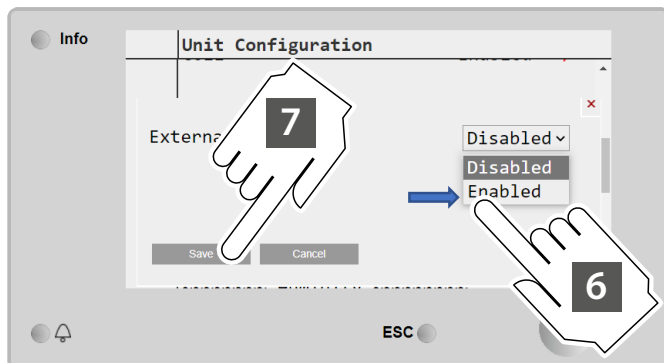
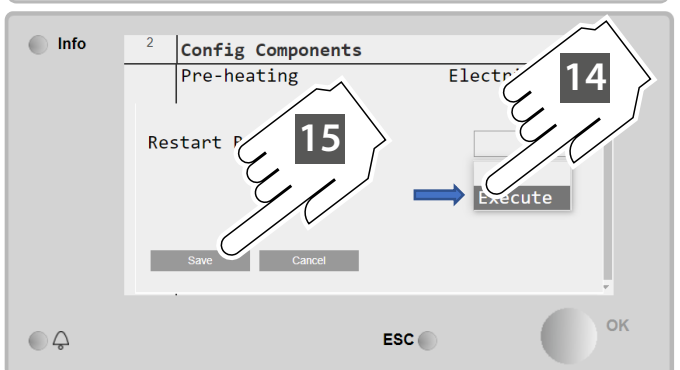
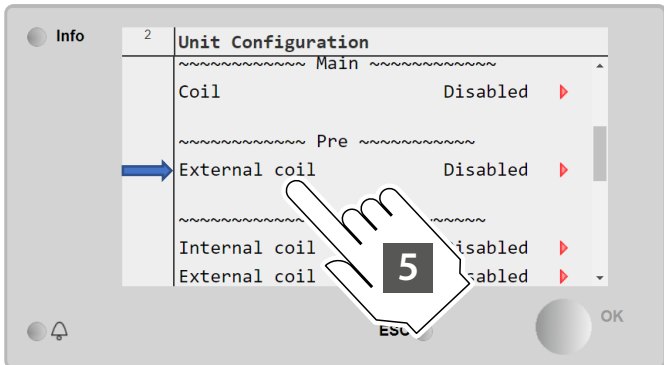
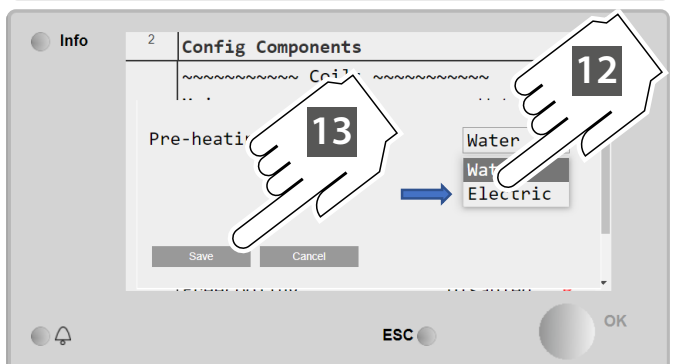
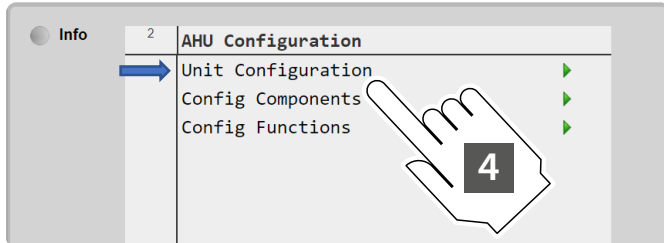
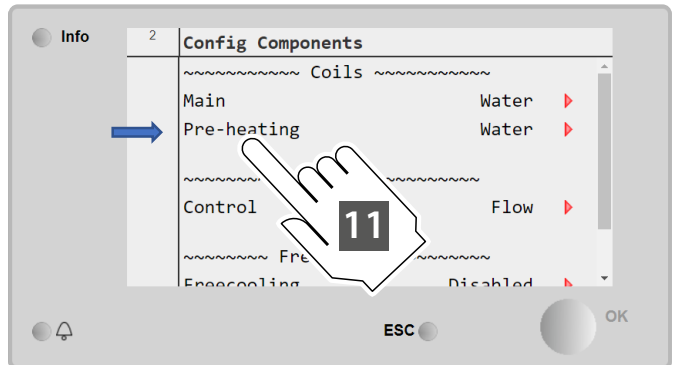
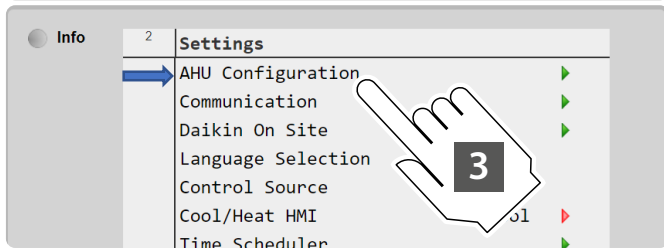
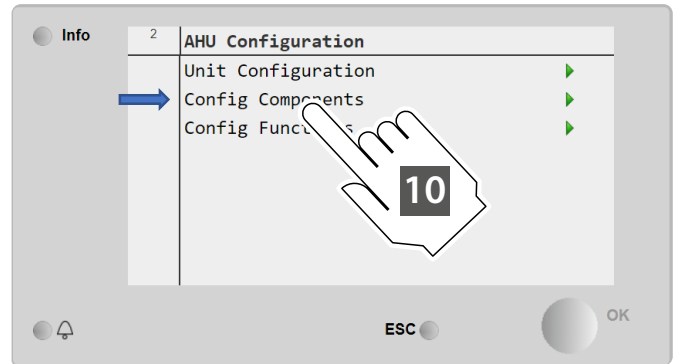
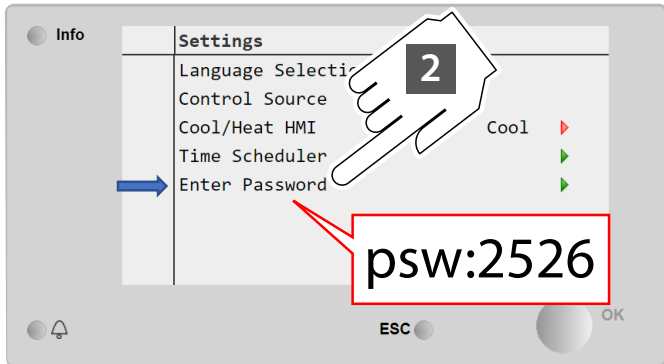
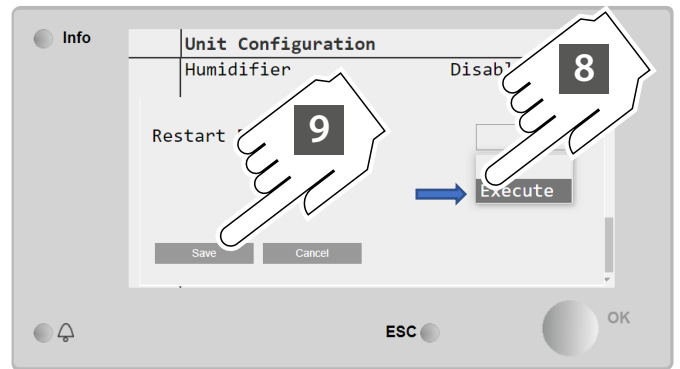
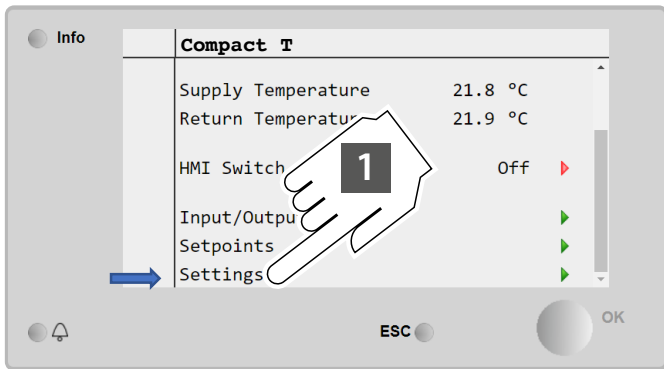

DAIKIN APPLIED EUROPE S.p.A. Via Piani S. Maria, 72 - 00072 Ariccia (Rome) Italy - www.daikinapplied.eu

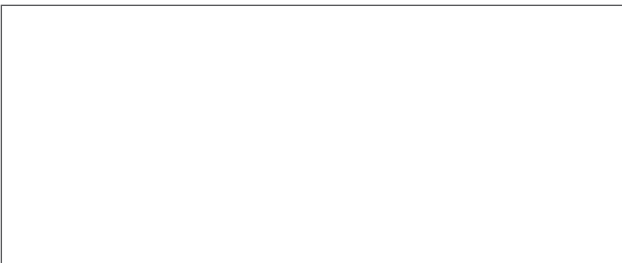

La presente pubblicazione è redatta solo come supporto tecnico e non costituisce impegno vincolante per Daikin Applied Europe S.p.A. Daikin Applied Europe S.p.A. ne ha compilato il contenuto al meglio delle proprie conoscenze. Nessuna esplicita o implicita garanzia è data per la completezza, precisione, affidabilità del suo contenuto. Tutti i dati e le specifiche in essa riportati sono soggetti a modifiche senza preavviso. Fanno fede i dati comunicati al momento dell'ordine. Daikin Applied Europe S.p.A. respinge esplicitamente qualsiasi responsabilità per qualsiasi danno diretto o indiretto, nel senso più ampio del termine, derivanti o connessi con l'uso e / o l'interpretazione di questa pubblicazione. Tutto il contenuto è protetto da copyright di Daikin Applied Europe S.p.A.

D-EIMOC2009-22_01EN